

NEW
PRODUCTS
SAVE UP TO 15%

* Till May 31, 2024 *

Dasqua® DIAL INDICATORS-GROUP 2

- Used to measure surface flatness as well as axial runout and also used to check tool set up and squareness.
- Limit indicator clips included.
- Strictly made in accordance with DIN878.
- Jeweled bearings on 5122-4215 and 5122-4220 provide the lowest possible bearing friction.
- Casting diameter: 58mm, shank diameter: 8mm
- Satin chrome plated steel case.

GROUP 2

Starting At
\$2893



.001" GRADUATION

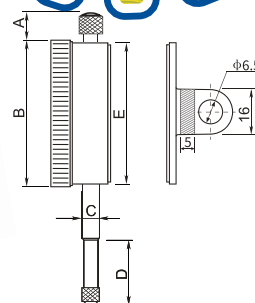

Replacement M2.5 x 0.45mm Point (Item #5260-9999)\$1.42(F)

Item#	Range	Scale divisions	Style	(mm)					Accuracy	Protection Standard	Sale (F)
				A	B	C	D	E			
5122-4210	0-1"	0.001"	lug back	8.5	58	8	40.9	53.5	0.002"	No Jeweled Bearing	28.93
5122-4220	0-1"	0.001"	lug back	8.5	58	8	40.9	53.5	0.002"	Jeweled Bearing	55.81
5122-4214	0-2"	0.001"	lug back	79.3	58	8	57.7	53.5	0.004"	No Jeweled Bearing	46.89
5122-4215	0-2"	0.001"	lug back	79.3	58	8	57.7	53.5	0.004"	Jeweled Bearing	71.77

PARTING TOOL HOLDERS - For Smaller Tool Posts

- HHIP parting tool holder fits standard 4-way tool post.
- Steel construction for durability and stability during the cutting process.
- The parting tool holder allows for efficient and controlled cutting when used to hold a cut-off blade on a lathe.

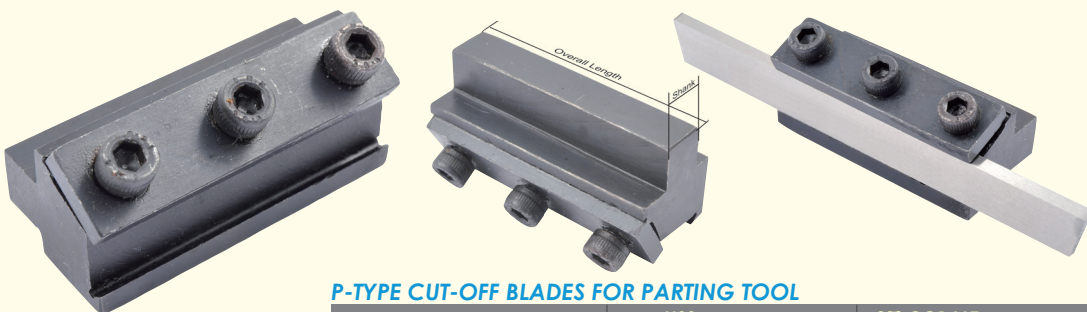

CLAMP TYPE

Item#	Shank	Length	Blade Used	Sale (F)
3906-5371	3/8"	2-3/16"	3/32 x 1/2"	10.66
3906-5372	1/2"	2-3/16"	1/8 x 3/4"	10.66

P-TYPE CUT-OFF BLADES FOR PARTING TOOL

Width	Height	Length	HSS Item#	Sale (F)	8% COBALT Item#	Sale (F)
3/32"	1/2"	4-1/2"	2000-6020	8.37	2000-7020	11.85
1/8"	3/4"	5"	2000-6050	12.27	2000-7050	16.73

Dasqua® LOCK'T MAGNETIC BASE

- All wear parts use hardened high grade steel and with hardness over HRC58.
- Inner structure is made of bearing steel, delivering more wear-resisting ability and longer service life.

Starting At
\$8525

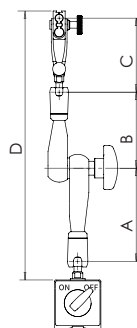

6mm, 8mm, 3/8"

- **Three clamping holes**
Designed with three clamping holes, which are suitable for metric and inch dial indicators, plus dovetail groove for test indicators, bringing great convenience & holding capabilities



- **Ergonomic design**
Ergonomic-designed tightening knob provides comfortable and firm grip; Flexible and super strong rotary joints, produce smooth adjustments in any direction or location

- **Super force locking mechanical universal arm**
New type locking mechanism, super strong arm lock and super tight locking force guarantees long life and firm positioning

- **CNC Machining**
Main parts produced on CNC machines, providing extremely accurate and high precision fit. Ensuring high quality and high stability



Item#	Power Pull	Base Dimensions	Thread Mount	(mm)			Reach Length (D)	Sale (F)
				A	B	C		
7121-0020	50kg	40x40x40	M6x1.00	62	52	79	220	85.25
7121-0025	80kg	60x50x55	M8x1.25	100	82	81	290	92.01
7121-0030	100kg	74x50x55	M8x1.25	145	95	81	355	107.60

NEW
PRODUCTS
SAVE UP TO 15%

* Till May 31, 2024 *

6PC TAPER PIPE (NPT) TAP SET

This HHIP 6 pc taper pipe tap set is made of carbon steel covering a size range of 1/8 to 1 inch, offering versatility and durability for various pipe threading applications.

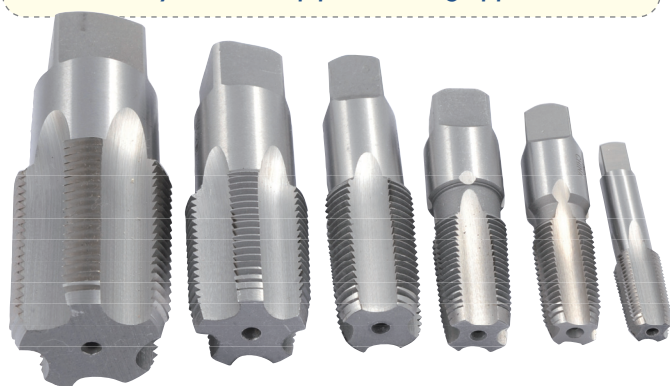

- **Tap Size Range:** Provides a comprehensive solution for various pipe threading needs.
- **Taper Rate:** Designed with a 3/4 inch per foot taper rate for gradual threading, ensuring a secure and leak-resistant pipe connection.
- **Material:** Crafted from carbon steel, ensuring longevity and reliability in challenging working conditions.
- **Versatile Applications:** Ideal for a wide range of applications requiring NPT threads, from plumbing to industrial pipe fitting.
- **Fitted Case:** included

6 PC SET	
Item	1011-3307
Sale Price	\$5607 (F)
Includes: 1/8~27, 1/4~18, 3/8~18, 1/2~14, 3/4~14 & 1~11-1/2	

GROUND THREAD • CARBON STEEL

HSS SINGLE FLUTE COUNTERSINKS & SETS

These HHIP HSS single flute countersinks and sets offer versatility, efficiency, and durability, making them especially suitable for portable machine work and applications involving smaller holes.

Material:

Crafted from durable high speed steel (HSS) for longevity and efficient cutting performance.

Single Flute Design:

Single flute for clean and precise cutting, suitable for deburring and chamfering.

Optimized for Smaller Holes:

The single-flute design allows for countersinking smaller holes compared to multi-flute tools.

Efficient Chip Evacuation:

Single flute design aids in efficient chip evacuation during cutting.

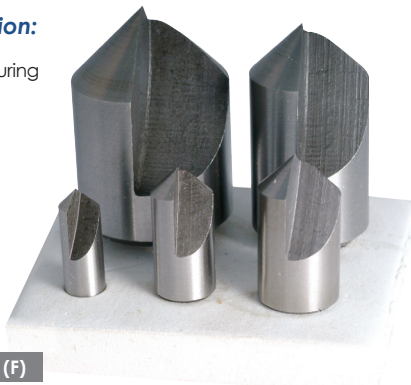

HIGH SPEED STEEL

5 PC. SETS:

1/4, 3/8, 1/2, 3/4 & 1"

Degree	Item#	Sale (F)
60°	2000-0030	45.17
82°	2000-0031	51.09
90°	2000-0032	53.13

Versatile Countersinks:

Ideal for various materials, including metals, wood, and plastics.

Various Sizes:

Available in a variety of sizes to accommodate different hole dimensions.

Diverse Chamfering Options:

Available in 60°, 82° and 90°, providing flexibility for your chamfering needs.

Advantages of Angle Options:

- **60°:** Enables quick chamfering, ideal for softer materials.
- **82°:** Offers balanced performance across a wide range of materials.
- **90°:** Provides a stronger chamfer, suitable for harder materials.

Professional and DIY Use:

Suitable for professional machining applications and DIY projects.

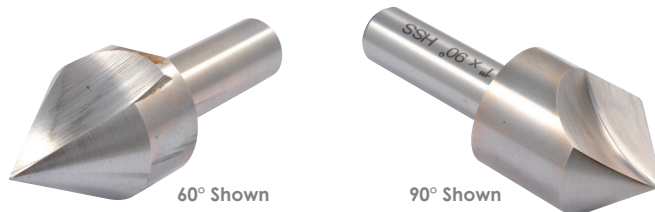

INDIVIDUALS (Inch)

Diameter Body	End	Dia. of Shank	OAL Approx.	60° Item#	82° Item#	90° Item#	Sale (F)
1/4	1/32	1/4	2	--	2001-0250	--	4.00
3/8	1/32	1/4	2	--	2001-0375	--	6.43
1/2	1/32	1/4	2	--	2001-0500	--	8.76
5/8	1/32	3/8	2-1/4	2001-0244	2001-0625	2001-0805	10.66
3/4	1/8	1/2	2-3/4	2001-0245	2001-0750	2001-0806	15.02
1	1/8	1/2	2-3/4	2001-0246	2001-1000	2001-0807	24.39
1-1/4	3/32	3/4	3	2001-0247	2001-1001	2001-0808	49.42

NEW PRODUCTS

SAVE UP TO 15%

* Till May 31, 2024 *

HSS 3-FLUTE CONTERSINKS & SETS

Ideal for countersinking screw and rivet heads, providing a flush and professional finish. Suitable for woodworking, metalworking, and general machining.

Diverse Chamfering Options:

Available in 60, 82, and 90 degrees, providing versatility for chamfering applications.

Optimized Chamfering:

- **60°:** Quick chamfering, ideal for softer materials.
- **82°:** Balanced performance across various materials.
- **90°:** Stronger chamfer, suitable for harder materials.

3-Flute Design:

Reduces chatter, ensuring smooth and precise cutting.

INDIVIDUALS (Inch)

82° Item#	Diameter Cutter	Shank	OAL Approx.	Sale (F)
2001-1250	1/4	3/16	1-1/2	6.37
2001-1375	3/8	1/4	1-3/4	7.57
2001-1500	1/2	3/8	2	9.97
2001-1625	5/8	3/8	2-1/4	15.98
2001-1750	3/4	1/2	2-5/8	20.96
2001-2000	1	1/2	2-3/4	27.91

HIGH SPEED STEEL



5 PC. SETS:

1/4, 3/8, 1/2, 3/4 & 1" Wood Stand Included

Degree	Item#	Sale (F)
60°	2001-2004*	58.95
82°	2001-2005	58.95
90°	2001-2006*	58.95

* NEW



HSS 82° 6-FLUTE COUNTERSINKS & SETS

- Efficient 82° angle for balanced chamfering.
- 6-flute design for reduced chatter and improved surface finish.
- Provides maximum rigidity with relatively short cutters.
- Used for precise countersinks in holes.
- Ideal for countersinking screw and rivet heads with precision.
- Versatile sets for woodworking, metalworking, and general machining.
- Wood stand included.
- **5 Pc Set includes:** 1/4, 3/8, 1/2, 3/4, 1". Sizes cover a range of common hole dimensions.
- **8 Pc Set Includes:** 1/4, 5/16, 3/8, 1/2, 5/8, 3/4, 7/8 & 1". Comprehensive set with additional sizes for a wider range of hole dimensions. Efficient for countersinking in diverse applications.

8 PC SET

Item	2001-3001
Sale Price	\$11216 (F)



HIGH SPEED STEEL • RIGHT HAND

INDIVIDUALS (Inch)

Item#	Size	Diameter Shank Dia.	Overall Length	Sale (F)
2001-3187	3/16	3/16	1-1/2	5.64
2001-3250	1/4	1/4	1-1/2	5.09
2001-3312	5/16	1/4	1-3/4	6.06
2001-3375	3/8	1/4	1-3/4	7.34
2001-3500	1/2	1/4	2-1/8	9.86
2001-3625	5/8	1/2	2-3/8	10.90
2001-3750	3/4	1/2	2-11/16	18.37
2001-3875	7/8	1/2	2-13/16	20.80
2001-4000	1	1/2	2-13/16	24.87
2001-4250	1-1/4	3/4	3-3/8	41.41
2001-4500	1-1/2	3/4	3-1/2	62.86
2001-4750	1-3/4	1	4-1/4	79.99
2001-4999*	2	1	4-3/8	60.15

* Limited Supply



NEW
PRODUCTS
SAVE
UP TO 15%

* Till May 31, 2024 *

HSS METRIC T-SLOT CUTTERS

- High speed steel.
- Rugged design with free cutting features.
- Cutters have positive radial rake, right and left hand spiral with alternate side cutting teeth for maximum chip clearance.
- **Purpose-Built Design:** Tailored for the precise cutting of t-slots.
- **Ideal for Milling Machines:** Optimized for use with milling machine to ensure accurate t-slot creation in metalwork.

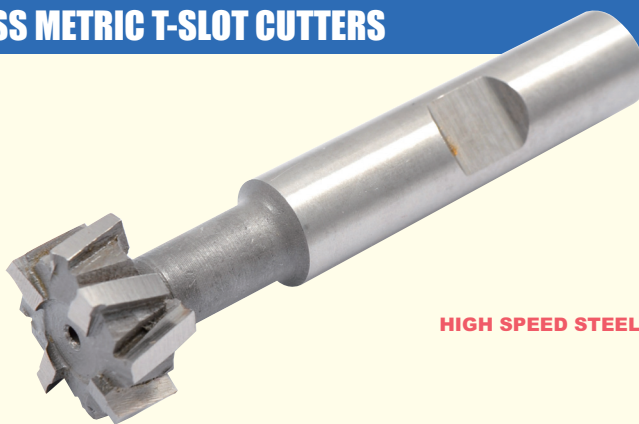

HIGH SPEED STEEL



INDIVIDUALS (Metric)

Bolt Size	Cutter Dia.	Cutter Width	Neck Dia.	Shank Dia.	OAL	Number of Teeth	Item#	Sale (F)
8	16	8	7	10	62	6	2006-0184	17.77
14	25	11	12	16	82	8	2006-0187	35.85

HSS SPIRAL FLUTE TAPER PIN REAMERS

- Spiral flute taper pin reamers are used to turn a straight hole into a tapered hole for standard taper pins.
- Generally used by hand, but can also be used with a machine.
- Recommended for applications where the reamer tends to wedge itself.
- The square on the shanks of the spiral fluted are suitable for holding in a tap wrench or vise
- The free cutting action at high speeds produces a good finish and minimizes chip packing in the flutes



HIGH SPEED STEEL

INDIVIDUALS (Inch)

Item#	Size	Shank Dia.	Diameter		Flute Length	OAL	Sale (F)
			Small End	Large End			
2006-2131	#3	15/64	.1813	.2294	2-5/16	3-11/16	7.65
2006-2132	#4	17/64	.2071	.2604	2-9/16	4-1/16	8.29
2006-2133	#5	5/16	.2409	.2994	2-13/16	4-5/16	9.14
2006-2134	#6	23/64	.2773	.3540	3-11/16	5-7/16	12.33
2006-2135	#7	13/32	.3297	.4220	4-7/16	6-5/16	16.79
2006-2136	#8	7/16	.3971	.5050	5-3/16	7-3/16	24.01
2006-2137	#9	9/16	.4805	.6055	3-1/16	8-5/16	35.28
2006-2138	#10	5/8	.5799	.7216	6-13/16	9-5/16	46.96

KNURLING WHEEL REPLACEMENT SETS

- Versatile and easy-to-use, these knurling wheel sets offer different patterns for diverse applications, enhancing the functionality and appearance of machined surfaces.
- **Thickness:** 5/16" wide.
- **Packaging:** Sold in pairs.
- **Patterns:** Available in Coarse, Medium, Fine, Diamond Pattern, and Straight Pattern.
- **Uses:** Ideal for adding textured patterns to workpieces for improved grip or aesthetic appeal.
- **How They Work:** The knurling wheels engage with the work piece surface. As pressure is applied, the wheels create the selected pattern through a rolling process. Patterns vary in aggressiveness, providing options for different applications.
- **Variety:** Coarse, Medium, and Fine for varying degrees of texture. Diamond Pattern for a unique surface finish. Straight Pattern for linear knurling effects.

SOLD IN PAIRS

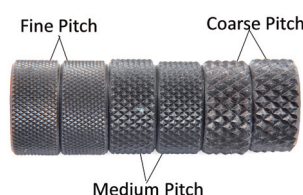
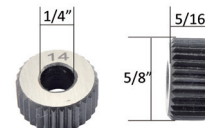
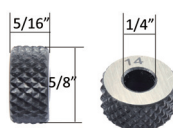

Pitch	TPI	Diamond Item#	Per Pair Sale (F)	Straight Item#	Per Pair Sale (F)
Coarse	14	2220-0314	2.98	2220-0114	2.98
Medium	21	2220-0316	2.98	2220-0116	2.98
Fine	33	2220-0318	2.98	2220-0118	2.98

Dimensions

Diameter		Thickness		Bore	
Inch	mm	Inch	mm	Inch	mm
5/8	16	5/16	7.90	1/4	6.35

NEW
PRODUCTS
SAVE UP TO 15%

* Till May 31, 2024 *

RE-MACHINEABLE MT TAPER BLANK END ARBORS - Drawbar End

- These can be machined as per individual requirement for mounting chucks etc.
- Made of quality tool steel-shanks are precisely ground.
- Adapt the blank end to serve as an adapter for transitioning between different tooling systems.
- Customize the end to attach specialized cutting tools, enabling precision in specific machining operations.

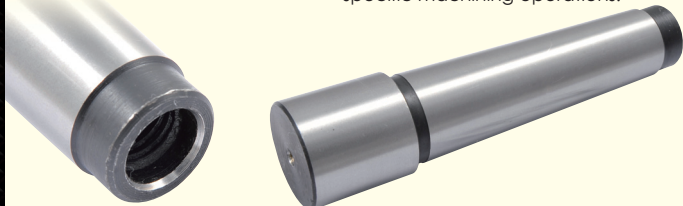

MT2 & Blank End (28x30mm)	
Item	3706-1002
Sale Price	\$1034 (F)
Drawbar Thread: M10x1.50	

MT3 & Blank End (28x28mm)	
Item	3706-1003
Sale Price	\$808 (F)
Drawbar Thread: M12x1.75	

HAND HELD DIAMOND DRESSER

- A reliable tool for hand-held precision dressing, this diamond dresser ensures the effective shaping of grinding wheels with ease.
- The fitted plastic handle offers a firm grip for optimal control during use. The diamond tip engages with the grinding wheel, ensuring consistent and efficient material removal.
- Shank is chrome plated.
- Useful tool for dressing wheels for surface grinders, universal grinders etc.

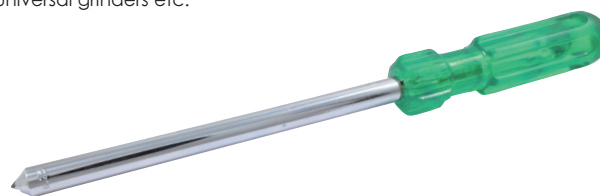

Item#	Diamond Size	Shank Dia.	Overall Length	Sale (F)
3900-0063	1/4 Carat	7/16"	8"	10.03

SINGLE-POINT DIAMOND DRESSERS - 3" & 6" SHANKS

Choose a 3" dresser for precision and smaller applications and a 6" dresser for efficiency, faster material removal and larger workpieces. The decision should align with the specific needs of the grinding operation.

- HHIP Single Point Diamond Dressers are used to reshape grinding wheels.
- Specifically designed with a diamond-tipped point for shaping, sharpening and cleaning grinding wheels by utilizing the hardness and abrasive nature of the diamond.
- The hard single-point diamond engages with the grinding wheel's abrasive surface.
- Effectively removes unwanted material, reshaping and conditioning the wheel for optimal performance.
- Guarantees precise dressing, achieving accurate profiles on grinding wheels.
- Enhances overall efficiency and longevity of grinding wheels in industrial applications.
- **Extended life:** Larger diamonds may have a longer lifespan due to reduced wear in each use.



3" SHANK

Carat (Approx.)	3/8 x 3" Item#	Sale (F)	7/16 x 3" Item#	Sale (F)	1/2 x 3" Item#	Sale (F)
1/4	3903-0032	7.63	3903-0042	7.63	3903-0092	8.16
1/3	3903-0033	10.29	3903-0043	11.24	3903-0093	12.03
1/2	3903-0034	14.80	3903-0044	14.22	3903-0094	16.65
3/4	3903-0035	23.15	3903-0045	22.08	3903-0095	24.91
1	3903-0039	28.09	3903-0050	28.09	3903-0099	28.09
1-1/2	3903-0040	28.54	3903-0051	28.54	3903-0100	28.54
2	3903-0041	35.58	3903-0052	35.58	3903-0101	35.58

6" SHANK

Carat (Approx.)	3/8 x 6" Item#	Sale (F)	7/16 x 6" Item#	Sale (F)	1/2 x 6" Item#	Sale (F)
1/4	3903-0200	6.26	3903-0210	6.26	3903-0220	6.26
1/3	3903-0202	7.04	3903-0212	7.04	3903-0222	7.04
1/2	3903-0204	12.51	3903-0214	12.51	3903-0224	12.51
3/4	3903-0206	17.60	3903-0216	17.60	3903-0226	17.60
1	3903-0207	18.77	3903-0217	18.77	3903-0227	18.77
1-1/2	3903-0208	28.15	3903-0218	28.15	3903-0228	28.15
2	3903-0209	37.54	3903-0219	37.54	3903-0229	37.54



NEW
PRODUCTS
SAVE
UP TO 15%

* Till May 31, 2024 *

R8 SHANK BORING HEAD SET - WITH CARBIDE TIPPED BORING BARS



Boring Head:

- 2-inch diameter for accurate and controlled boring.
- Adjustable slides for precise depth control.
- Hardened and ground for durability and accuracy.
- Graduations on the dial for direct reading at increments of 0.005".

Carbide Tipped Boring Bars:

- Set includes 5 C6 carbide-tipped boring bars for various applications.
- Carbide tips provide superior cutting durability.
- Different bar sizes for versatility in bore sizes.

R8 Shank:

- R8 shank for secure and stable tool holding. Fits Bridgeport-type mills.
- Threaded back for adapting shank, ensuring a secure fit.
- 7/16"-20 drawbar thread.

Chatter-Free Boring:

- Design minimizes chatter for smoother machining.
- Enhances surface finish and overall machining quality.

Precision Machining>>>>>

Achieve high-precision bores for accurate fits. Reduce scrap and rework with reliable cutting performance.

Versatility>>>>>

Adapt to different machining needs with the variety of boring bar sizes. Ideal for both professionals, hobbyists and machinists.

Adjustments>>>>>

Use the adjustable slides to set the desired depth of cut.

Reading the Dial>>>>>

Each division on the dial corresponds to a specific depth increment. Direct reading graduation of 0.005" for precise depth control.

Feed Dial>>>>>

Monitor the feed dial for precise control over the cutting speed. Graduated at 0.001" per 0.050" for fine-tuning the feed rate.

Chatter-Free Boring>>>>>

Minimizes chatter for smoother machining. Enhances surface finish and overall quality.

45° Flycutter:

- 5/16" hole diameter.
- Enhances versatility for additional machining needs.
- Ideal for facing and surface milling operations.

Carrying Case:

- Includes a durable carrying case for convenient storage.
- Protects the set from damage and ensures all components are organized.

Boring Head Set Includes:

- 2" boring head
- R8 shank
- 5 pc. C6 carbide tipped boring bar set
- 45° fly cutter and protective case

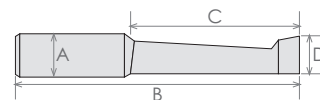

BORING BAR SET INCLUDES:

A Diameter	B Length	C Bore Depth	D Min. Bore
1/2	3-1/16	1-1/2	5/16
1/2	3-1/4	1-3/4	1/2
1/2	3-7/8	2-3/8	7/16
1/2	3-7/8	2-3/8	9/16
1/2	4-1/2	3-1/16	9/16



Item#	Head Size	Shank Taper	Shank To Head	Tool Capacity	Dia. of Boring	Sale (E)
1061-0106	2"	R8	1-1/2"~18	Up to 1/2"	3/8~5"	120.70

NEW
PRODUCTS
SAVE UP TO 15%

* Till May 31, 2024 *

BT30 SHANK BORING HEAD SET - WITH CARBIDE TIPPED BORING BARS

Precision Machining>>>>>

Achieve high-precision bores for accurate fits. Reduce scrap and rework with reliable cutting performance.

Versatility>>>>>

Adapt to different machining needs with the variety of boring bar sizes. Ideal for both professionals, hobbyists and machinists.

Adjustments>>>>>

Use the adjustable slides to set the desired depth of cut.

Reading the Dial>>>>>

Each division on the dial corresponds to a specific depth increment. Direct reading graduation of 0.005" for precise depth control.

Feed Dial>>>>>

Monitor the feed dial for precise control over the cutting speed. Graduated at 0.001" per 0.050" for fine-tuning the feed rate.

Chatter-Free Boring>>>>>

Minimizes chatter for smoother machining. Enhances surface finish and overall quality.



BT30 Shank:

- Designed to work with machines featuring BT30 spindles, providing a versatile solution for a wide range of machining equipment.

Chatter-Free Boring:

- Design minimizes chatter for smoother machining.
- Enhances surface finish and overall machining quality.

45° Flycutter:

- 5/16" hole diameter.
- Enhances versatility for additional machining needs.
- Ideal for facing and surface milling operations.

Carrying Case:

- Includes a durable carrying case for convenient storage.
- Protects the set from damage and ensures all components are organized.

Boring Head:

- 2-inch diameter for accurate and controlled boring.
- Adjustable slides for precise depth control.
- Hardened and ground for durability and accuracy.
- Graduations on the dial for direct reading at increments of 0.005".

Carbide Tipped Boring Bars:

- Set includes 5 C6 carbide-tipped boring bars for various applications.
- Carbide tips provide superior cutting durability.
- Different bar sizes for versatility in bore sizes.



Boring Head Set Includes:

- 2" boring head
- BT30 shank
- 5 pc. C6 carbide tipped boring bar set
- 45° fly cutter and protective case

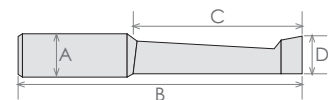

BORING BAR SET INCLUDES:

A Diameter	B Length	C Bore Depth	D Min. Bore
1/2	3-1/16	1-1/2	5/16
1/2	3-1/4	1-3/4	1/2
1/2	3-7/8	2-3/8	7/16
1/2	3-7/8	2-3/8	9/16
1/2	4-1/2	3-1/16	9/16

Item#	Head Size	Shank Taper	Shank To Head	Tool Capacity	Dia. of Boring	Sale (E)
1061-0096	2"	BT30	1-1/2"~18	Up to 1/2"	3/8~5"	120.70

NEW
PRODUCTS
SAVE
UP TO 15%

* Till May 31, 2024 *

MT2 & MT3 SHANK BORING HEAD SET - WITH CARBIDE TIPPED BORING BARS



Boring Head:

- 2-inch diameter for accurate and controlled boring.
- Adjustable slides for precise depth control.
- Hardened and ground for durability and accuracy.
- Graduations on the dial for direct reading at increments of 0.005".

Carbide Tipped Boring Bars:

- Set includes 5 C6 carbide-tipped boring bars for various applications.
- Carbide tips provide superior cutting durability.
- Different bar sizes for versatility in bore sizes.

MT2 & MT3 Shanks:

- Secure tool holding, fits machines with a Morse Taper #2 or 3 spindle, providing a versatile solution for a wide range of machining equipment.
- Threaded back for adapting shank, ensuring a secure fit.
- 3/8"-16 drawbar thread.



Precision Machining>>>>>

Achieve high-precision bores for accurate fits. Reduce scrap and rework with reliable cutting performance.

Versatility>>>>>

Adapt to different machining needs with the variety of boring bar sizes. Ideal for both professionals, hobbyists and machinists.

Adjustments>>>>>

Use the adjustable slides to set the desired depth of cut.

Reading the Dial>>>>>

Each division on the dial corresponds to a specific depth increment. Direct reading graduation of 0.005" for precise depth control.

Feed Dial>>>>>

Monitor the feed dial for precise control over the cutting speed. Graduated at 0.001" per 0.050" for fine-tuning the feed rate.

Chatter-Free Boring>>>>>

Minimizes chatter for smoother machining. Enhances surface finish and overall quality.

Chatter-Free Boring:

- Design minimizes chatter for smoother machining.
- Enhances surface finish and overall machining quality.

45° Flycutter:

- 5/16" hole diameter.
- Enhances versatility for additional machining needs.
- Ideal for facing and surface milling operations.

Carrying Case:

- Includes a durable carrying case for convenient storage.
- Protects the set from damage and ensures all components are organized.

Boring Head Set Includes:

- 2" boring head
- MT2 & MT3 shanks
- 5 pc. C6 carbide tipped boring bar set
- 45° fly cutter and protective case

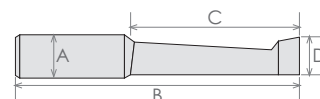

BORING BAR SET INCLUDES:

A Diameter	B Length	C Bore Depth	D Min. Bore
1/2	3-1/16	1-1/2	5/16
1/2	3-1/4	1-3/4	1/2
1/2	3-7/8	2-3/8	7/16
1/2	3-7/8	2-3/8	9/16
1/2	4-1/2	3-1/16	9/16

Item#	Head Size	Shank Taper	Shank To Head	Tool Capacity	Dia. of Boring	Sale (E)
1061-0074	2"	MT2 & MT3	1-1/2"~18	Up to 1/2"	3/8~5"	119.00

NEW
PRODUCTS
SAVE UP TO 15%

* Till May 31, 2024 *

NMTB30 SHANK BORING HEAD SET - WITH CARBIDE TIPPED BORING BARS

Precision Machining>>>>>

Achieve high-precision bores for accurate fits. Reduce scrap and rework with reliable cutting performance.

Versatility>>>>>

Adapt to different machining needs with the variety of boring bar sizes. Ideal for both professionals, hobbyists and machinists.

Adjustments>>>>>

Use the adjustable slides to set the desired depth of cut.

Reading the Dial>>>>>

Each division on the dial corresponds to a specific depth increment. Direct reading graduation of 0.005" for precise depth control.

Feed Dial>>>>>

Monitor the feed dial for precise control over the cutting speed. Graduated at 0.001" per 0.050" for fine-tuning the feed rate.

Chatter-Free Boring>>>>>

Minimizes chatter for smoother machining. Enhances surface finish and overall quality.

Boring Head:

- 2-inch diameter for accurate and controlled boring.
- Adjustable slides for precise depth control.
- Hardened and ground for durability and accuracy.
- Graduations on the dial for direct reading at increments of 0.005".

Carbide Tipped Boring Bars:

- Set includes 5 C6 carbide-tipped boring bars for various applications.
- Carbide tips provide superior cutting durability.
- Different bar sizes for versatility in bore sizes.



NMTB Shank:

- Secure tool holding, fits machines with a NMTB30 spindle.
- Threaded back for adapting shank, ensuring a secure fit.
- 1/2"-13 drawbar thread.

Chatter-Free Boring:

- Design minimizes chatter for smoother machining.
- Enhances surface finish and overall machining quality.

45° Flycutter:

- 5/16" hole diameter.
- Enhances versatility for additional machining needs.
- Ideal for facing and surface milling operations.

Carrying Case:

- Includes a durable carrying case for convenient storage.
- Protects the set from damage and ensures all components are organized.

Boring Head Set Includes:

- 2" boring head
- NMTB30 shank
- 5 pc. C6 carbide tipped boring bar set
- 45° fly cutter and protective case

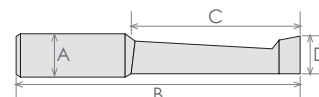

BORING BAR SET INCLUDES:

A Diameter	B Length	C Bore Depth	D Min. Bore
1/2	3-1/16	1-1/2	5/16
1/2	3-1/4	1-3/4	1/2
1/2	3-7/8	2-3/8	7/16
1/2	3-7/8	2-3/8	9/16
1/2	4-1/2	3-1/16	9/16



Item#	Head Size	Shank Taper	Shank To Head	Tool Capacity	Dia. of Boring	Sale (E)
1061-0058	2"	#30NMTB	1-1/2"~18	Up to 1/2"	3/8~5"	120.70

NEW PRODUCTS

SAVE UP TO 15%

* Till May 31, 2024 *

R8 BORING HEAD SETS - WITH INDEXABLE BORING BARS

- Indexable boring bars take carbide inserts (included).
- Head features a threaded back for interchangeable shanks.
- Set complete with Boring Head, Boring Shank, Indexable Boring Bars, Torx & L-shape Hex Wrenches and fitted carrying case.
- A micrometer lead screw provides 0.001" direct reading accuracy and ease of adjusting.

- 1 DIV = 0.001 meaning **on the 0-50 dial**, when turning the dial by 1 division/graduation, the boring head's travel is 0.001" in radius movement, 0.002" in diameter movement; **on the 0-100 dial**, when turning the dial by 1 division/graduation, the boring head's travel is 0.0005" in radius movement, 0.001" in diameter movement.



1906-0201 Shown

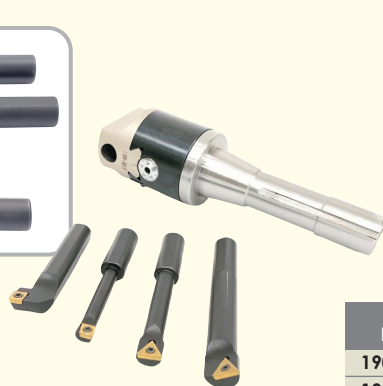

1906-0205 Shown



C6 GRADE: carbide for steel and alloy steel

SPECIFICATIONS:

	2" HEAD	3" HEAD
Graduations	0.001"/0-50	0.001"/0-100
Boring Head Thread	1-1/2"-18 T.P.I.	1-1/2"-18 T.P.I.
Offset	5/8"	1"
Crosshole	1/2"	3/4"
Shank Thread (Drawbar End) R8	7/16"-20 UNC	7/16"-20 UNC
Min. Boring Diameter	0.394"	0.394"
Max. Boring Diameter	5.906"	7.874"
Max. Boring Depth	1.970"	3.150"

BORING BAR SET INCLUDED

Set	Shank	Min. Bore	(Inch) OAL	Bore Depth	For Holder	Uses Insert	Uses Torx Wr.	Uses Screw
4	1/2	5/16	3-3/8	1-7/8	B10C2	CCMT21.5	T-8	M2.5x5.0
		7/16	3-3/4	2-1/4	B12T2	TCMT21.5		
		9/16	4-1/8	2-3/4	B16T2	TCMT21.5		
		3/4	2-7/8	1-7/16	R100C2	CCMT21.5		
5	3/4	5/16	3-3/8	1-7/8	D10C2	CCMT21.5	T-8	M2.5x5.0
		7/16	3-3/4	2-3/8	D12T2	TCMT21.5		
		1/2	4-1/8	2-3/4	D16T2	TCMT21.5		
		11/16	5-5/16	3-7/8	D20T2	TCMT21.5		
		1-1/16	5-1/8	3-9/16	R125C3	CCMT32.5		

R8 BORING HEAD SET - WITH HSS BORING BARS

- Rugged design allows excellent rigidity for chatter-free boring.
- Head features a threaded back for interchangeable shanks.
- Set complete with Boring Head, Boring Shank, Solid HSS Boring Bars & L-shape Hex Wrenches and fitted carrying case.
- Dial on head with 0.001" graduation for accurate hole sizing.

SPECIFICATIONS:

	2" HEAD
Boring Head Thread	1-1/2"-18 T.P.I.
Offset	5/8"
Crosshole	1/2"
Shank Thread (Drawbar End) R8	7/16"-20 UNC
Min. Boring Diameter	0.300"
Max. Boring Diameter	5.700"
Max. Boring Depth	2.300"



Item#	Boring Head (Dia.)	Shank	No. of Boring Bars	Boring Bar Hole Size	Sale (F)
1906-5935	2"	R8	5	1/2"	110.37



Dasqua®

IP54 WATER RESISTANT HEAVY DUTY DIGITAL ELECTRONIC CALIPER LONG JAW - 6" JAW LENGTH



CABLE
03

DIN
862

mm
in

Data
output

- With sturdy frame and big size for high stability.
- Made of solid stainless steel.
- Made in accordance with **DIN862**.
- With data-output and metric-inch conversion function.
- IP54 protection against liquid.
- Includes CR2032 battery and hard plastic case.

- Extended reach - 6" jaw length.
- Longer jaws contribute to more accurate measurements and facilitate the measurement of larger, longer objects or hard-to-reach areas.
- **Buttons on caliper:**
ON/OFF: Power on/off switch
ABS/INC: Relative/absolute measurement
ZERO: Zero setting button
mm/in: metric/inch conversion
SET: presetting button
HOLD: data hold button
- Fine adjustment.

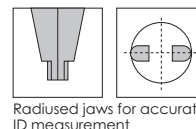

Radiused jaws for accurate ID measurement

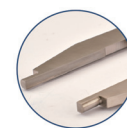

Long Jaw

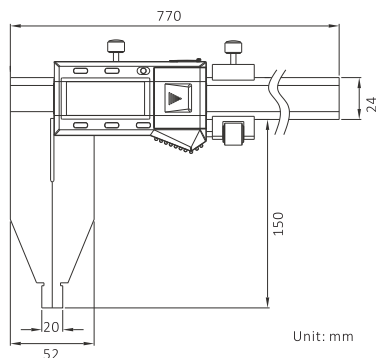

**INCH/METRIC
.0005" RESOLUTION**

Item#	Range	Reading	(mm)					Accuracy	Sale (F)
			L1	L2	L3	W1	T1		
2220-8165	0-24"/0-600mm	0.01mm / 0.0005"	770	44	100	24	20.32	0.05mm/0.002"	244.96

5 AXIS MILLING WORK STOP - 5/8" TABLE SLOTS

Enables versatile and precise positioning of workpieces for complex machining tasks. Offers a cost-effective solution for achieving accurate and repeatable setups without compromising quality. Simple and straightforward design for easy installation and usage. Despite the low cost, designed with durable materials to withstand machining forces and ensure long-term reliability. For use with repetitive jobs that require exact placement in the vise.

- 5 Axis Adjustment, 5/16" diameter x 6" length stop rod, locking lever can be positioned at 360 degrees.
- T nut fits 5/8" table slots.
- Height 8", Length 8"

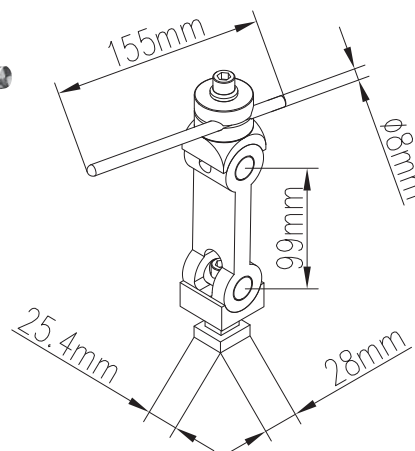

Item 3900-2117
Sale Price **\$3642**
(F)

NEW

PRODUCTS

SAVE UP TO 15%

Till May 31, 2024

Dasqua®

SHOCK-PROOF 6" DIAL CALIPER
WITH FREE DEPTH GAGE ATTACHMENT & 1" GAGE BLOCK

- The entire body jaws are vacuum hardened with uniform hardness, guaranteeing longer wear-resistance and longer service life.
- The upper and lower parts of the slide scale body are precisely ground to ensure smooth operation.
- Tough shock-proof gearing
- Use for measuring outside diameter, inside diameter, step and depth
- Made of solid stainless steel
- Strictly made in accordance with DIN862
- Distinct lines and figures laser etched against satin chrome finish
- With locking screw for stable reading
- Large dial for easy and clear reading
- Includes dial caliper, free depth gage attachment and fitted case.



DIN 862

SHOCK-PROOF

DOUBLE SHOCK-PROOF

Item 2210-8280

Sale Price \$5621 (F)

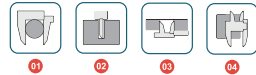
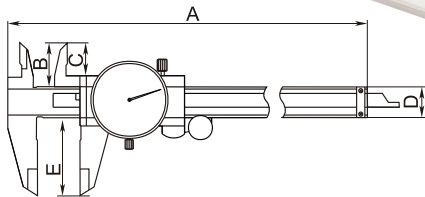
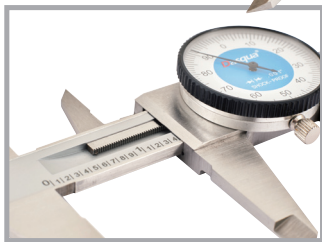
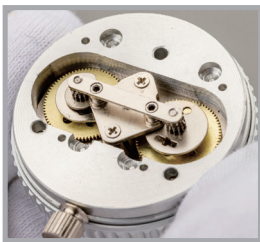

Caliper

Range	Graduation	(mm)					Accuracy
		A	B	C	D	E	
0-6"	0.001"	236	21	16.5	16	40	0.001"

Depth Base

(mm)					Application
A	B	C	D	E	
16.5	9	75	18	30	Base Length 75mm; for width of the beam 16mm

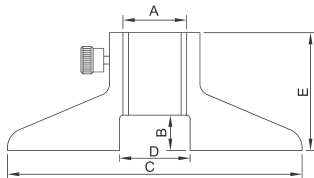

Dasqua®

CALIPER DEPTH BASE ATTACHMENT

- Increases the stability of the caliper when measuring the depth of a hole or recess.
- Made of solid stainless steel
- Measuring surfaces ground for ultimate accuracy

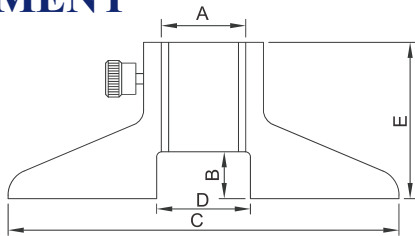
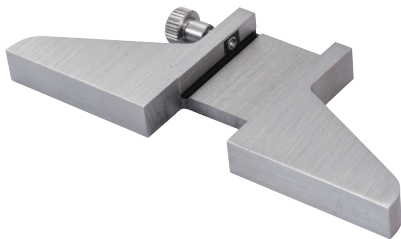

Item#	(mm)					Application	Sale (F)
	A	B	C	D	E		
3001-1001	16.5	9	75	18	30	Base Length 75mm; for width of the beam 16mm	18.65



Dasqua® 1" DIAL INDICATOR (GROUP 2)

- Hardened metal construction for longer life.
- Stable and high accuracy.
- Made in accordance to ASME B89.1.10M-2001
- Extra flannelette bag to protect the dial indicator for repeated usage.
- Stem: 3/8"
- Dial Face: 2"
- 4-48 Thread



Item#	Range	Graduation	Style	Accuracy	Hysteresis	Sale (F)
5122-4212	0-1"	0.001"	Lug Back	±2	0.33	19.39



Dasqua® 2PC MAGNETIC BASE WITH FINE ADJUSTMENT & 1" DIAL INDICATOR SET

MAGNETIC BASE

- Holding power 60kg
- Fine adjustment
- On/off switch
- Power Pull: 132 lbs
- Overall Height: 9"
- Max Reach: 16"
- Hold most of AGD group indicators with stem 4mm/8mm/3/8" diameter.
- Base: 2" (Width) x 2.36" (Depth) x 2.2" (Height)

0~1" DIAL INDICATOR

- Graduation: .001"
- Lug back
- Contact point thread 4-48
- Stem: 3/8"
- Dial Face: 2"

Item#	Range	Dial Indicator Item#	Magnetic Base Item#	Sale (F)
7611-2010	0-1"	5122-4212	7123-1004	37.05

Dasqua® DIGITAL ELECTRONIC CALIPERS

DIN 862

mm/in/f

IP54 COOLANT & FLUID RESISTANT

Battery CR2032

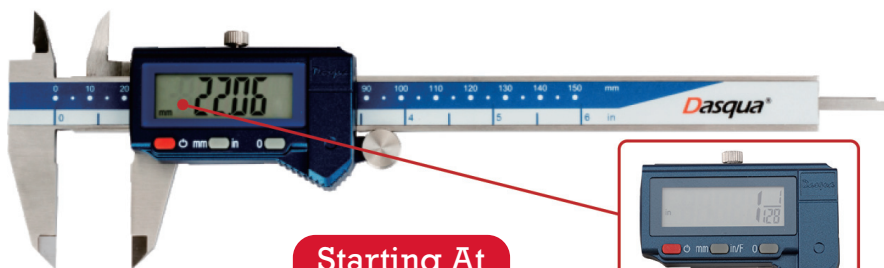

Starting At
\$54.50



Fraction

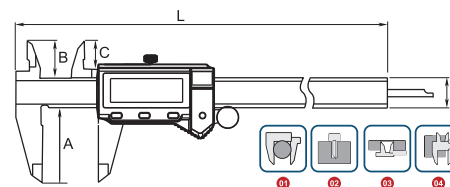

- NEW Advanced design.
- Strictly made in accordance with DIN862.
- Silky smooth movement throughout.
- Hardened, ground and lapped measuring surfaces.



CERTIFICATE

Dasqua	
Certificate No.	18072028
Client	Dasqua
Product	Digital Indicator
Model	5122-4212
Range	0-1"
Accuracy	±2
Resolution	0.001"
Calibration	Pass
Inspector	Paul

REPLACEMENT BATTERY (ITEM #4102-0032).....\$2.68

Item#	Range	Reading	(mm)					Accuracy	Sale (F)
			A	B	C	D	L		
9020-1005	0-6"/0-150mm	0.01mm / 0.0005" / 1/128"	40	20	15.5	16	235	0.02mm/0.001"	54.50
2000-1010	0-8"/0-200mm	0.01mm / 0.0005" / 1/128"	50	24	19.5	16	287	0.03mm/0.0015"	83.96
2000-1015	0-12"/0-300mm	0.01mm / 0.0005" / 1/128"	60	26	21.5	16	390	0.03mm/0.0015"	113.70

NEW
PRODUCTS
SAVE UP TO 15%

* Till May 31, 2024 *

Dasqua® SUPER POWER (80 kg/176 lb) MAGNETIC BASE WITH FINE ADJUSTMENT



Item **7123-1005**
Sale Price **\$2491 (F)**

- 150° V-grooved base can be placed on the cylindrical surfaces as well as flat surfaces for easily fixing the indicators.
- Well selected ferrite permanent magnet with magnetic force greater than calibration value
- On/off switch for magnet, easy to move the base without the influence of magnetic force.

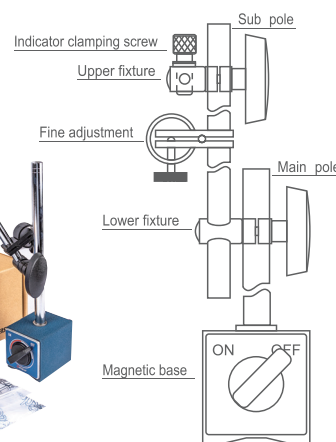

SPECIFICATIONS:

Holding Power	Base	Main Pole	Sub Pole	(mm) Dia. of Clamp Hold	Weight
80kg	60x50x55	Ø12x176	Ø10x150	Ø4 / Ø8 / Ø3/8"	1.5kg



Dasqua® STANDARD MAGNETIC BASE

- Solid structure with electroplated surfaces, precision ground end-faces
- With clamp holes of 4mm, 8mm & 3/8", which satisfy the use of most indicators, test indicators and scribes.
- 150° V-grooved base can be placed on the cylindrical surfaces for easily fixing the indicators
- Well selected ferrite permanent magnet with magnetic force greater than calibration value
- On/off switch for magnet, easy to move the base without the influence of magnetic force

Item **7700-0010**
Sale Price **\$2363 (F)**

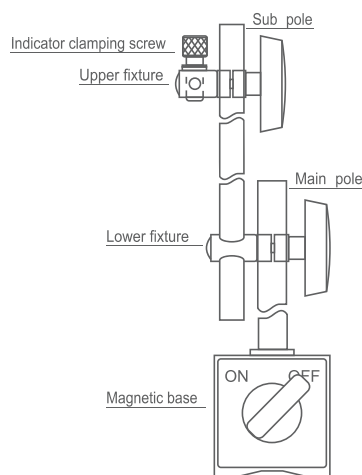

SPECIFICATIONS:

Holding Power	Base	Main Pole	Sub Pole	(mm) Dia. of Clamp Hold	Weight
80kg	58x50x55	Ø12x177	Ø10x165	Ø4 / Ø8 / Ø3/8"	1.6kg

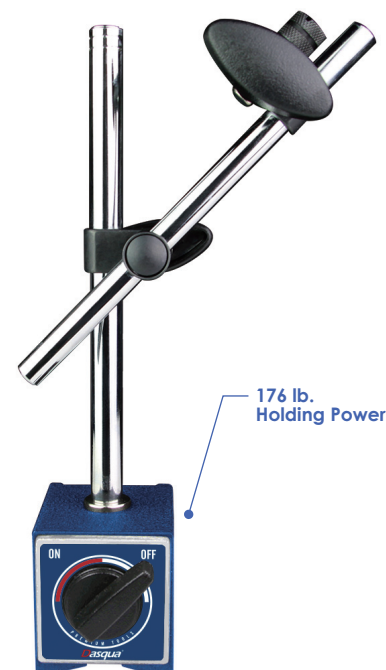



Dasqua® ELECTRONIC DIGITAL OUTSIDE MICROMETER WITH STAINLESS STEEL SPINDLE

- Spindle ground twice which makes pitch error 1μ less than before and reaches world-class standard

- New special carbide used on measuring anvil instead of traditional easy-wear off carbide tip

- Stainless steel newly adapted on spindle instead of carbon steel

0-1" Range
Item 4230-2005
Sale Price \$7478 (F)

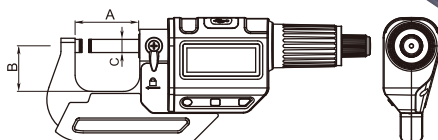

INCH/METRIC
.0005" RESOLUTION

- With ratchet stop for constant force (5- 8N 20% higher than normal)



SPECIFICATIONS:

Range	Resolution	(mm)			Accuracy
		A	B	C	
0-1"/0-25mm	0.00005"/0.001mm	31.5	22.5	Ø6.5	0.00012"/0.003mm

Dasqua® 0~0.5" DIAL INDICATOR-Group 2

- Used to measure surface flatness as well as axial runout and also used to check tool set up and squareness.
- Limit indicator clips included.
- Strictly made in accordance with DIN878.
- Casting diameter: 58mm, shank diameter: 8mm
- Satin chrome plated steel case.

GROUP 2

DIN 878

.0005" GRADUATION

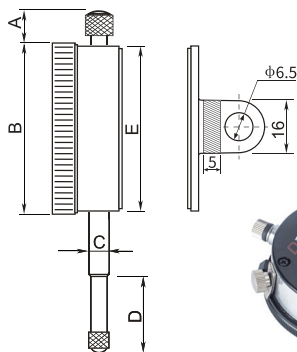

3/8" Stem



4-48 Thread

0-0.5" Range
Item 5122-4205
Sale Price \$2670 (F)

SPECIFICATIONS:

Range	Graduation	Style	(mm)					Accuracy
			A	B	C	D	E	
0-0.5"	0.0005"	lug back	10.5	58	Ø8	20.5	Ø53.5	0.0005"



NEW
PRODUCTS
SAVE UP TO 15%

* Till May 31, 2024 *



Dasqua® 0-22" DIAL DEPTH GAGE KIT

- Used to measure depth of holes or parts with grooved or elevated surfaces.
- Dial Indicator for easy and clear reading.
- Hardened base with fine lapped contact surface.
- Extension rods of different lengths offering larger measuring ranges.

.001" GRADUATION

0~22" Range

Item **5822-4100**

Sale Price **\$10340 (F)**

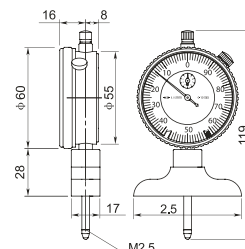

Dasqua® DIGITAL ELECTRONIC OUTSIDE MICROMETERS



DIN 863

mm/in

- Large, easy-to-read digital display.
- Class A in electrostatic discharge.
- Carbide-tipped anvils.
- Measuring spindle hardened and ground.

- Extremely hardened stable one-piece spindle.
- Ratchet stop.
- Metric and Inch conversion.



Starting At
\$5562

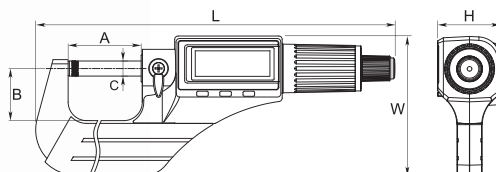

Item#	Range	Resolution	Dimensions (mm)						Accuracy	Sale (F)
			A	B	C	L	W	H		
4210-2105	0-1" / 0-25mm	0.00005" / 0.001mm	31.5	22.5	Ø6.5	155	60.2	27.3	0.003mm/0.00015"	55.62
4210-2110	1-2" / 25-50mm	0.00005" / 0.001mm	56.5	31	Ø6.5	185.4	77.9	27.3	0.003mm/0.00015"	72.53
4210-2115	2-3" / 50-75mm	0.00005" / 0.001mm	81.5	44	Ø6.5	211.9	93.4	27.3	0.004mm/0.00015"	90.70
4210-2120	3-4" / 75-100mm	0.00005" / 0.001mm	107.1	56	Ø6.5	239.9	111.4	27.3	0.004mm/0.00015"	106.97
4210-2125	4-5" / 100-125mm	0.00005" / 0.001mm	132	66	Ø6.5	269.7	127.8	27.3	0.005mm/0.0002"	130.96
4210-2130	5-6" / 125-150mm	0.00005" / 0.001mm	156.5	80	Ø6.5	296	145	27.3	0.005mm/0.0002"	155.46

Dasqua® DIAL INDICATOR WITH MAGNETIC BACK - GROUP 2

- Indicator strictly made in accordance with DIN 878.
- Permanent powerful magnet.
- Fitting for all group 2 dial indicator.
- Magnet screws off.
- Magnetic force: 20KG.
- Fitted case.

Magnetic Back Only

Item **5111-1010**

Sale Price **\$887 (F)**

Magnetic Back with Indicator Kits

Item#	Indicator Included	Indicator Range	Graduation	Stem Dia.	Sale (F)
5111-0001	5111-0000	0-10mm	0.01mm	8mm	45.35
5122-4211	5111-4210	0-1"	0.001"	3/8"	39.73

5111-1010 Shown

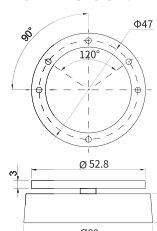

GROUP 2





Dasqua® TAPER BORE GAGES -For Measuring Hole Diameter

- Made of polished stainless steel.
- Sizes engraved to last longer and read easily.

Overall Length: 7-1/2"



Mainly used to measure some deeper slots, holes and tube diameters.



Item#	Range	Graduation	Accuracy	Sale (F)
1051-0005	1 - 6.5mm	0.1mm	±0.05	47.16
1051-0008	3 - 15mm	0.1mm	±0.05	50.31

Dasqua® CIRCULAR TAPER BORE GAGES -For Measuring Small Holes

- Used to measure grooves and gaps or places that are hard to reach.
- Made of stainless steel
- Protective cap to cover the tip to avoid injuring the user.

Overall Length: 4.65"



Item#	Range	Graduation	Sale (E)
1051-2010	0.1-5mm	0.1mm	65.34

Dasqua® METRIC OUTSIDE MICROMETER

- Strictly made in accordance with DIN 863.
- With ratchet stop for constant pressure.
- Spindle thread hardened, ground and lapped for ultimate accuracy.

- Clear graduations laser-etched on satin chrome finish for easy reading.
- With spindle lock.
- Made with thermal protection frame.



DIN
863

Item#	Range	Graduation	Case	Sale (F)
4111-6405	0-25mm	0.01mm	Plastic Box	28.08

NEW
PRODUCTS
SAVE
UP TO 15%

* Till May 31, 2024 *

Dasqua® 12 PC TELESCOPING GAGE COMBO SET

- Durable action (self-centering) for quick checking of inside measurements.
- Great tool for easy and accurate measurements of the true sizes of holes and slots.
- Satin chrome finish.
- Rigid handle with self-centering feature.
- Constant spring tension for uniform feel & smooth operation.
- Contact plunger automatically self-centering at all times and in all positions.
- Contact point ends are hardened tool steel and precision ground on a radius of the smallest hole the gage will enter.
- Includes fitted case.

Long-Reach 6pc Set

(Inch) Set Range	OAL
5/16~1/2	12"/300mm
1/2~3/4	12"/300mm
3/4~1-1/4	12"/300mm
1-1/4~2-1/8	12"/300mm
2-1/8~3-1/2	12"/300mm
3-1/2~6.0	12"/300mm

Long Reach Set
(Up To 12") Shown

Includes

Item#	Set	Range	Depth	Sale (F)
5911-0001	6PC Long Reach Set	5/16-1/2", 1/2-3/4", 3/4-1-1/4", 1-1/4-2-1/8", 2-1/8-3-1/2", 3-1/2-6"	up to 12"	64.89
5911-0002	6PC Standard reach set	5/16-1/2", 1/2-3/4", 3/4-1-1/4", 1-1/4-2-1/8", 2-1/8-3-1/2", 3-1/2-6"	up to 5.85"	38.03

Standard Set
(Up To 5.85") Shown

**COMBO SET
FOR EASY ACCESS
TO MEASUREMENTS!**

12PC Combo Set

Item	59111-9999
Sale Price	\$9715 (F)

Standard 6pc Set

(Inch) Set Range	OAL
5/16~1/2	4.20
1/2~3/4	4.40
3/4~1-1/4	4.40
1-1/4~2-1/8	5.85
2-1/8~3-1/2	5.85
3-1/2~6.0	5.85

Dasqua® .0005" GRADUATION DIAL BORE GAGE SETS

- Self centering.
- Carbide anvils.
- Easy-to-read.
- Insulated cover.
- Chrome plated handle.
- Includes extension holder and fitted case.



The Biggest Measuring Range Set In Industry!
Two Popular Bore Gauge Ranges Combined In One Set!



Starting At
\$11595



5512-6130 Shown

Item#	Measuring Range	Depth Up to	Sale (F)
5512-6105	0.24-0.4"	1.55"	158.35
5512-6110	0.4-0.7"	4"	153.46
5512-6115	0.7-1.5"	6"	119.37
5512-6120	1.4-2.4"	6"	119.37
5512-6125	2-4"	6"	119.37
5512-6130	2-6"	6"	115.95
5510-0000	1.4-6"	6"	186.99

NEW
PRODUCTS
SAVE UP TO 15%

* Till May 31, 2024 *

Dasqua® 400x250mm GRANITE SURFACE PLATE

- Meet DIN876, grade A is for inspection room or lab.
- Made of granite, free from deterioration or dimensional change over time, minimal changes in dimension due to temperature changes.
- High density structure thus extremely homogeneous.
- Surface plate is lapped and has a satin matt finish to prevent glare.
- 100% corrosion proof.
- Non-magnetic and non-conductive.
- Measuring instruments and test equipment are easy to slide over surface. For measuring tasks, layout work, touching up and lapping precision parts.



Grade A, 0-Ledge

Item#	(mm) L x W x H	Flatness Grade A	Weight	Sale (F)
8500-4025	400x250x60	0.0029mm	41 lbs.	105.75

Dasqua® DIGITAL ELECTRONIC DOUBLE-BEAM HEIGHT GAGE

- Heavy duty construction for industry use.
- Large LCD display.
- Zero-setting at any position.
- Double stainless beams assure high accuracy.
- Base is hardened, ground and lapped for maximum flatness.
- Carbide tipped scriber for sharp, clean lines.
- On/Off switch ABS/INC switchable and hold function.
- Micro-adjustable wheel for easy head displacement/precision positioning.



**INCH/METRIC
.0005"/.01MM
GRADUATION**

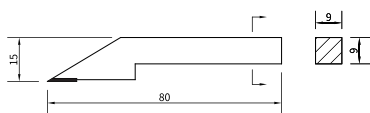

Replacement Scriber (Item# 3130-4115)....\$24.42

Item#	Range	Accuracy	Sale (F)
3230-8105	0-12"/0-300mm	+/- 0.002"/0.04mm	467.44

Dasqua® ABSOLUTE DIGITAL ELECTRONIC HEIGHT GAGE

- Built-in absolute liner encoder, no need to set the reference point at every power-on.
- Carbide tipped scriber for sharp, clean lines.
- With SPC data output.
- Large, easy-to-read LCD display.
- Rigid, heavy duty beam and base.
- Made of stainless steel.

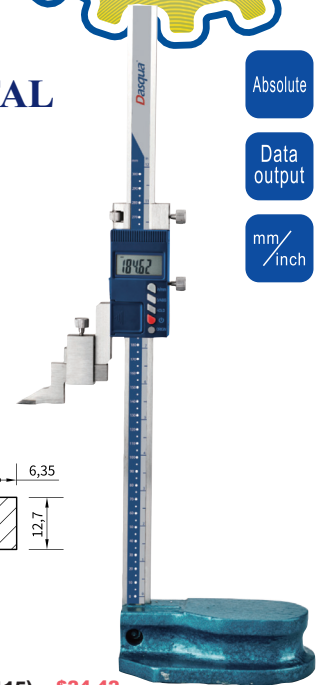
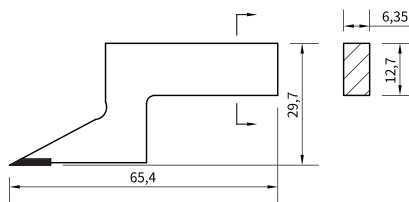

Absolute

Data
output

mm/
inch

Replacement Scriber (Item# 3130-4115)....\$24.42

Item#	Range	Resolution	Accuracy	Sale (F)
3130-8115	0-300/0-12"	0.01/0.0005"	±0.04	243.62

Dasqua® DOUBLE-BEAM DIAL HEIGHT GAGE

- Provided with a dial and two digit counters for more accurate reading.
- Double-beam ensures higher measuring accuracy.
- One counter reads in the plus direction and the other reads in the minus direction.
- With a feed wheel on the back.
- Carbide tipped scriber for sharp, clean lines.
- Both counters and dial can be re-zeroed at any scriber position.
- Base hardened, ground and lapped for maximum flatness.
- Dustproof shield optional.



Item#	Range	Resolution	Graduation	Sale (F)
3222-4205	0-12"	0.001"	0.1"	273.87

NEW
PRODUCTS
SAVE UP TO 15%

* Till May 31, 2024 *

Dasqua® WATERPROOF DIGITAL IP65 Z-AXIS SETTERS



0.001MM RESOLUTION

- Accuracy (tolerance range): $\pm 0.002\text{mm}/0.0001"$,
Repeatability: $0.003\text{mm}/0.0001"$
- 3V Lithium battery CR2032

Starting At
\$119³⁰

• Used to help tool setting

Can be used in IP65 working environment
(with inductive measurement against splash water)
and will not damage the tool edge

• Resolution reaches 0.001mm

Higher than other zero setting devices

• Lighting indicating at "0"

More obvious and accurate compared to
mechanic zero setting device

• With magnetic base

Fixed on machine steadily and shorten
tool setting time and improve work
efficiency greatly

• Provided in fitted aluminum case

Item#	Height	Resolution	Sale (F)
1801-1005	50mm	0.001mm/0.00005"	119.30
1801-1010	100mm	0.001mm/0.00005"	186.45

GROMMET SETTING DIES

- Manufactured from solid steel for inserting sheet
brass washer & teeth grommets.
- Useful tool for setting up eyelets.

Item#	For Eyelet Size	Sale (F)
8606-2281	10mm	10.34
8606-2282	13mm	11.31



NEW
PRODUCTS
SAVE UP TO 15%

* Till May 31, 2024 *

ADJUSTABLE TAILSTOCKS - For Rotary Tables



Item#	Fits Table	Adjustable Height (Min.-Max.)	Weight (lbs.)
3906-2406	4~6"	42~92mm/1.65~3.62"	6.2
3906-2407	6~8"	93~125mm/3.66~4.92"	22.5

The height can be varied when working with different index centers, while the angle of inclination can be changed for various machining applications. In addition, the tip of the carrier is finely rotatable. Clamping is made by tightening the bolts.



Fits 4~6" Rotary Table

Item 3906-2406

Sale Price **\$6426** (F)

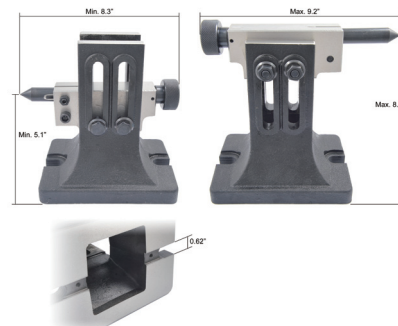
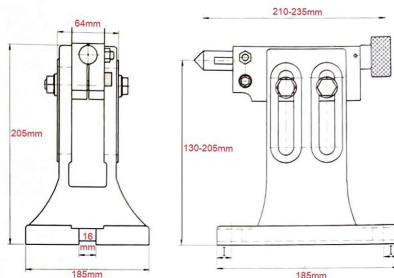

Fits 6~8" Rotary Table

Item 3906-2407

Sale Price **\$6899** (F)

Dasqua® METRIC OUTSIDE MICROMETERS & SET

DIN 863

- Strictly made in accordance with DIN 863.
- With ratchet stop for constant pressure.
- Spindle thread hardened, ground and lapped for ultimate accuracy.
- Clear graduations laser-etched on satin chrome finish for easy reading.
- With spindle lock.
- Carbide measuring surfaces ground for longer service life.
- Standards included above 0-25mm micrometer.
- Fitted case.

3PC Set
0~75mm Range
Item 4111-8206
Sale Price **\$11930** (F)

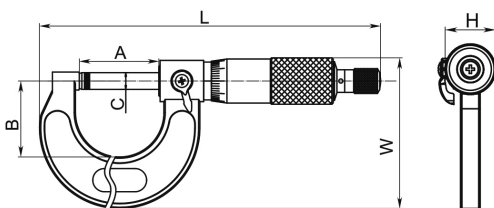

- Carbide measuring surface (Hardness ≥ 89HRA) guarantees longer working life and higher wear resistance.



- Strictly made in accordance with DIN 863

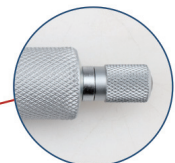

- Ratchet rolls smoothly and evenly

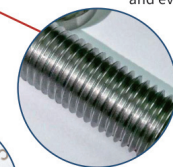

- Micrometer screw is precisely ground

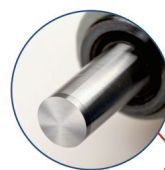

- Laser inscription and engraving on barrel and thimble satin chrome finish

.01MM GRADUATION

Item#	Range	(mm)						Accuracy	Sale (F)
		A	B	C	L	W	H		
4111-8105	0-25mm	31	29.5	Ø6.5	133	58.5	Ø18	0.004"	33.26
4111-8110	25-50mm	56	38	Ø6.5	137.2	76	Ø18	0.004"	42.09
4111-8115	51-75mm	81	51	Ø6.5	162.7	91	Ø18	0.005"	45.66
4111-8130	125-150mm	156	89	Ø6.5	263.8	142	Ø18	0.006"	68.87

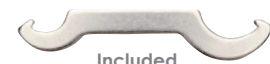

Included



5" HORIZONTAL & VERTICAL PRECISION ROTARY TABLE

- Rotary table is precision ground.
- Low profile design.
- Worm gear is easily disengaged for free rotation.
- Rotary table parts are strategically positioned for easy access.
- The one piece worm and shaft are hobbled from solid alloy steel.
- Graduated 360 degrees.
- 10 second vernier reading.
- One rotation of handle equals 4° on collar.

5" ROTARY TABLE	
Item	3906-2305
Sale Price	\$21675 (F)
Wt. 20 Lbs	

SPECIFICATIONS:

Table Size (Dia.)	Center Hole	Vert. Center Height	Horizontal Overall Height	Vertical Overall Height	Number of T-slots	T-slot Width	Gear Ratio	Weight (lbs.)
4.92"	2M.T.	3-5/8"	3.3"	7"	4	7/16"	90:1	20

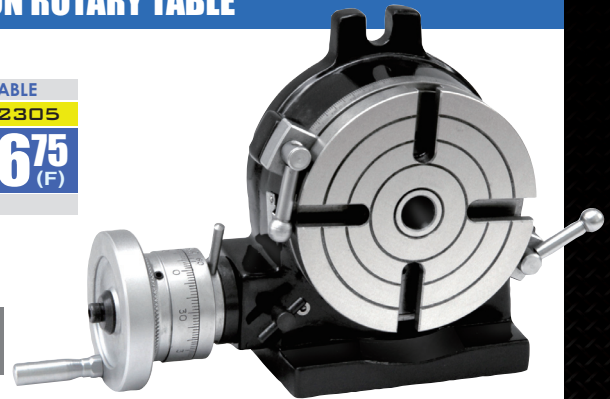

10" HORIZONTAL & VERTICAL PRECISION ROTARY TABLE

- Rotary table is precision ground.
- Low profile design.
- Worm gear is easily disengaged for free rotation.
- Rotary table parts are strategically positioned for easy access.
- The one piece worm and shaft are hobbled from solid alloy steel.
- 10 second vernier reading.
- One rotation of handle equals 4° on collar.
- Graduated 360 degrees.

10" ROTARY TABLE	
Item	3906-2310
Sale Price	\$41438 (F)
Wt. 85 Lbs	

SPECIFICATIONS:

Table Size (Dia.)	Center Hole	Vert. Center Height	Horizontal Overall Height	Vertical Overall Height	Number of T-slots	T-slot Width	Weight (lbs.)
10"	3M.T.	6.5"	4.5"	12.6"	6	0.55"	85

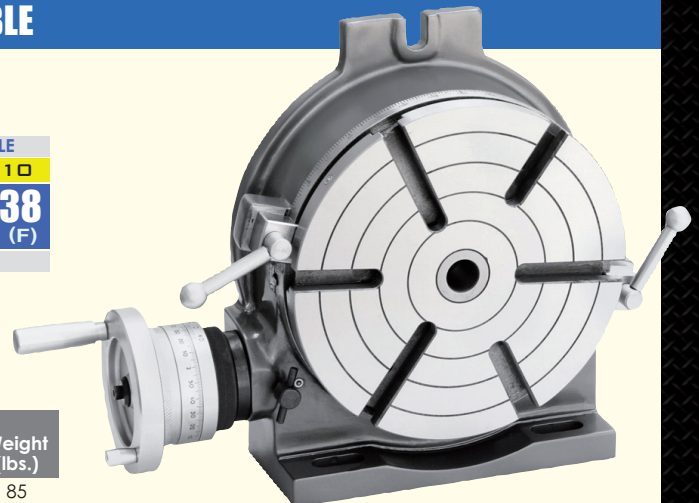

ADJUSTABLE TAILSTOCK - For Rotary Tables

- Adjustable height: 5.2~8.1"

Fits 8~12" Rotary Table	
Item	3906-2411
Sale Price	\$11322 (F)

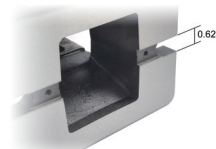
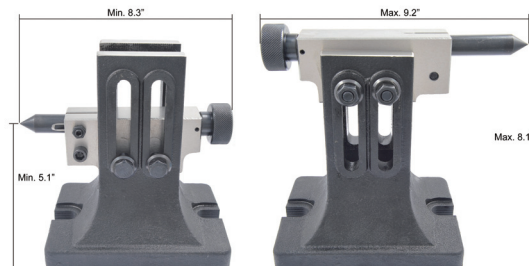
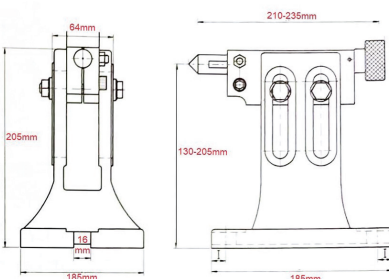

The height can be varied when working with different index centers, while the angle of inclination can be changed for various machining applications. In addition, the tip of the carrier is finely rotatable. Clamping is made by tightening the bolts.



NEW
PRODUCTS
SAVE UP TO 15%

* Till May 31, 2024 *

6" ROTARY TABLE KIT

KIT INCLUDES:

Rotary Table, Dividing Plates, Tail Stock, Clamping Kit & 4-Jaw Self-Centering Lathe Chuck With Mounting Plate

- Rotary table is precision ground.
- Low profile design .
- Worm gear is easily disengaged for free rotation.
- Rotary table parts are strategically positioned for easy access.
- The one piece worm and shaft are hobbled from solid alloy steel.
- 10 second vernier reading.
- One rotation of handle equals 4° on collar.
- Graduated 360 degrees

6" Rotary Table Kit	
Item	3906-2316
Sale Price	\$548 ²⁵ (F)
Wt. 51 Lbs	

**BUY A
COMPLETE KIT
& SAVE!**

Table Size (Dia.)	Center Hole	Vert. Center Height	Horizontal Overall Height	Vertical Overall Height	Number of T-slots	T-slot Width
6"	2MT	3.9"	3.1"	8.1"	4	0.43"

ROTARY TABLE

- Rotary tables can be used in a horizontal or vertical position and with a lathe chuck.

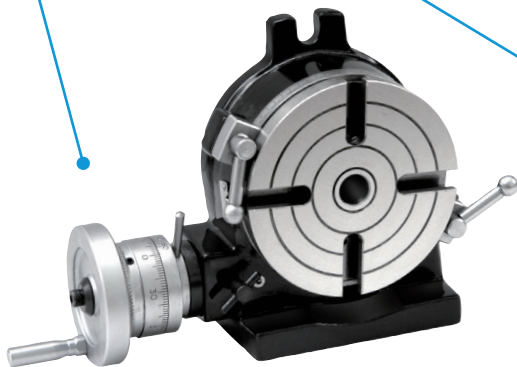

DIVIDING PLATES

- Suitable for rotary tables.
- Set includes: index plates, crank handle, 3 screws, sector & U washer.

SET INCLUDES:

Plate A - 26, 30, 34, 38, 41, 44, 47, 51, 57, 28, 32, 37, 39, 43, 46, 49, 53, 59

Plate B - 62, 67, 71, 77, 81, 87, 91, 97, 63, 69, 73, 83, 89, 93, 99



Dividing Plate Set

ADJUSTABLE TAIL STOCK

- Adjustable height: 3.2~4.3"

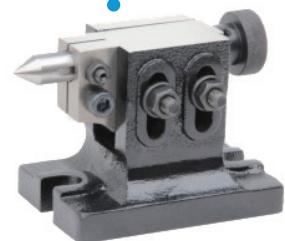

Tail Stock



Rotary Table & 4-Jaw Chuck with Aluminum Plate



Clamping Kit

4" 4-JAW SELF-CENTERING LATHE CHUCK

- Made of high grade tool steel.
- Universal scroll chuck.
- 2 sets of solid jaws included (ID & OD).
- Chuck wrench included.

16 PC CLAMPING KIT

- Drop forged steel.
- All parts are case hardened and heat treated.

EACH KIT CONTAINS:

For 6" Rotary Table: 16PC Two pc each of Step Clamp, Step Block, and Four PC each of Stud, T-slot Nut & Flanged Nut.

NEW
PRODUCTS
SAVE UP TO 15%

* Till May 31, 2024 *

8" ROTARY TABLE KIT

KIT INCLUDES:

Rotary Table, Dividing Plates, Tail Stock, Clamping Kit & 4-Jaw Self-Centering Lathe Chuck With Mounting Plate

- Rotary table is precision ground.
- Low profile design.
- Worm gear is easily disengaged for free rotation.
- Rotary table parts are strategically positioned for easy access.
- The one piece worm and shaft are hobbled from solid alloy steel.
- 10 second vernier reading.
- One rotation of handle equals 4° on collar.
- Graduated 360 degrees

8" Rotary Table Kit	
Item	3906-2318
Sale Price	\$726⁷⁵ (F)
Wt. 111 Lbs	

**BUY A
COMPLETE KIT
& SAVE!**

Table Size (Dia.)	Center Hole	Vert. Center Height	Horizontal Overall Height	Vertical Overall Height	Number of T-slots	T-slot Width
8"	3MT	5.3"	4.1"	10.4"	4	0.55"

ROTARY TABLE

- Rotary tables can be used in a horizontal or vertical position and with a lathe chuck.

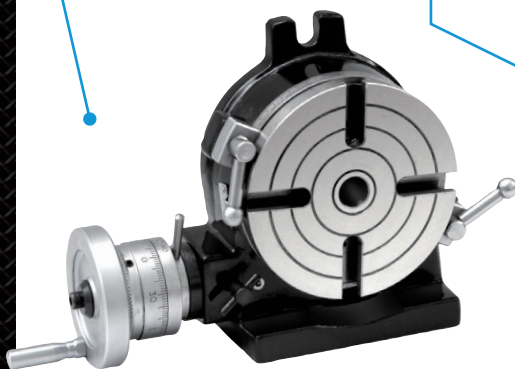

DIVIDING PLATES

- Suitable for rotary tables.
- Set includes: index plates, crank handle, 3 screws, sector & U washer.

SET INCLUDES:

Plate A - 26, 30, 34, 38, 41, 44, 47, 51, 57, 28, 32, 37, 39, 43, 46, 49, 53, 59

Plate B - 62, 67, 71, 77, 81, 87, 91, 97, 63, 69, 73, 83, 89, 93, 99



Dividing Plate Set

ADJUSTABLE TAIL STOCK

- Adjustable height: 4.5~5.7" for 8" Rotary Table



Tail Stock



Rotary Table & 4-Jaw Chuck with Aluminum Plate



Clamping Kit



10 PC CLAMPING KIT

- Drop forged steel.
- All parts are case hardened and heat treated.

EACH KIT CONTAINS:

For 8" Rotary Table: Two pc each of Step Clamp, Step Block, Stud, T-slot Nut & Flanged Nut.

5" 4-JAW SELF-CENTERING LATHE CHUCK

- Made of high grade tool steel.
- Universal scroll chucks.
- 2 sets of solid jaws included (ID & OD).
- Chuck wrench included.



NEW
PRODUCTS
SAVE UP TO 15%

* Till May 31, 2024 *

Pro-Series VISE SPEED HANDLES

- Designed for milling vises and used for other applications.
- Speed up the clamping force of the vise.
- Fits most milling vises with same hex hub.
- Hub made of aluminum and handles are made of steel.

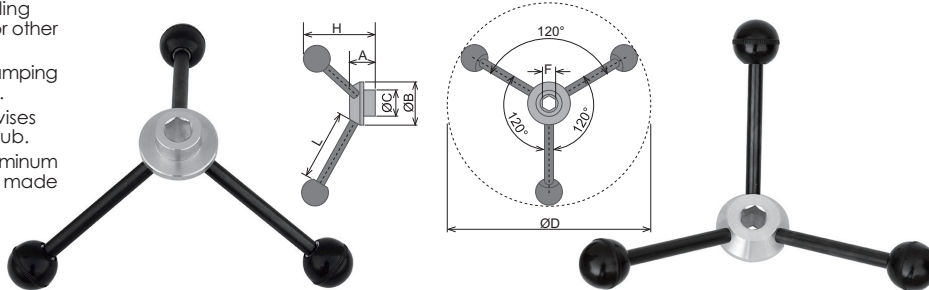

SPECIFICATIONS:

Item#	Hex Hub (F)	Max Dia. (D)	Depth (H)	Hub Height (A)	Hub Dia. (B)	Dia. (C)
3906-0200	9/16	12"	4-1/2	1-3/8	2-1/2	1-3/8
3906-0201	5/8	12"	4-1/2	1-3/8	2-1/2	1-3/8
3906-0202	3/4	12"	4-1/2	1-3/8	2-1/2	1-3/8

Fits 9/16" Hex Hub

Item **3906-0200**
Sale Price **\$2746** (F)

Fits 5/8" Hex Hub

Item **3906-0201**
Sale Price **\$2746** (F)

Fits 3/4" Hex Hub

Item **3906-0202**
Sale Price **\$2746** (F)

QUICK CLAMP WORK STOPS - For Machine Vise

- Fits mill vises with 3/8~7/8" thick jaws
- Steel body

- Very handy for small parts that do not require the full length of vise jaws.

- Clamps quickly & easily to the top of existing hard jaws or soft jaws

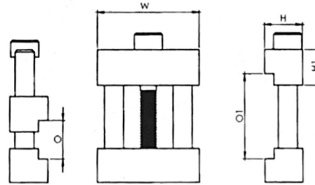

3/8~3/4" Capacity

Item **3906-2131**
Sale Price **\$1173** (F)

1/2~7/8" Capacity

Item **3906-2132**
Sale Price **\$1173** (F)

SPECIFICATIONS:

Item#	Min. Cap. (O)	Max Cap. (OI)	Width (W)	Thick. (H1)	Thick. (H)
3906-2131	3/8	3/4	1	3/8	3/8
3906-2132	1/2	7/8	1-1/2	1/2	1/2

3" & 4" ROUND MACHINE VISE FOR ROTARY TABLES

- Made from tool steel.
- Hardened and ground.
- Low profile.
- Mounting holes for easy attachment to rotary table or slides on milling table.
- Mounting T-nut and cap screws included.
- V-groove for holding round parts.

3" Vise

Item **3906-2213**
Sale Price **\$4077** (F)

4" Vise

Item **3906-2214**
Sale Price **\$4292** (F)

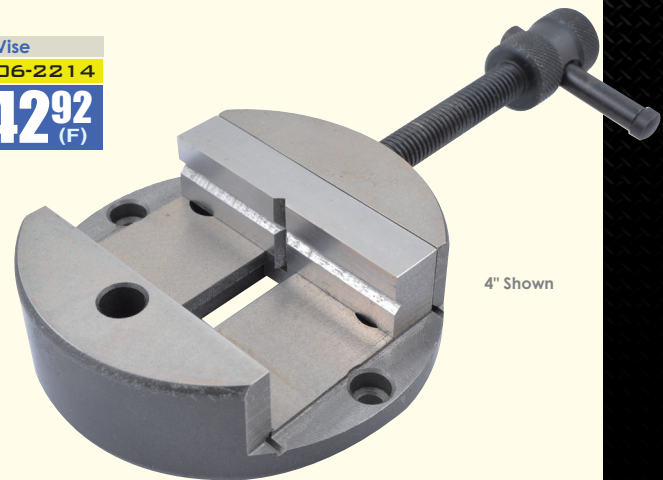
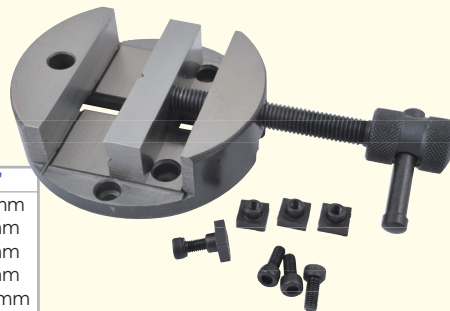

4" Shown

SPECIFICATIONS

	3"	4"
T-nut Width	7.8mm	7.6mm
Jaw Width	64mm	80mm
Jaw Depth	20mm	20mm
Jaw Opening	28mm	40mm
Base Diameter	80mm	100mm

NEW PRODUCTS

SAVE UP TO 15%

* Till May 31, 2024 *

ALUMINUM & STEEL SOFT VISE JAWS

- Fits **Kurt Anglock™**, **HHIP** & similar precision milling machine vises.
- Ensures stable and secure grip on workpieces.
- Guards against surface damage or marring during clamping.
- **Material Compatibility:**
 - **Aluminum:** Suited for softer materials.
 - **Steel:** Ideal for heavy-duty machining with robust materials.
- Perfect for easy and quick set-ups, reducing down time.
- Customize jaws for drill or mill features.



3900-2291 Shown



3900-2297 Shown

SOLD SET OF 2PCS

For Vise Size	Height A	Length B	Hole Space D	Screw Size E	Hole Size F	Jaw Thick. C	Material	Item#	Set of 2pc Sale (E)
4"	1-1/2	4-1/8	2.500	0.59	.413	1	Aluminum	3900-2291	18.45
4"	1-1/2	4-1/8	2.500	0.59	.413	1	Steel	3900-2297	27.02
6"	2	6-1/8	3.875	0.79	.530	1	Aluminum	3900-2293	16.09
6"	2	6-1/8	3.875	0.79	.530	1	Steel	3900-2298	21.18

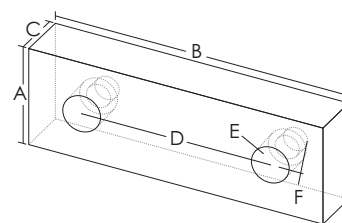

MT2 SLOTTING SAW ARBOR

Morse Taper Slotting Saw Arbor offers a reliable and precise solution for slotting operations. Its robust construction and adjustable capacity make it a valuable tool.

- Accepts saw blades from 1/2" to 1"
- Blades are firmly secured in position with hex head screw
- MT2 shank with secure M10 draw bar.
- High-quality steel
- Great for precision slotting saw tasks.



Item 3906-0143
Sale Price **\$1389** (F)

DIMENSIONS:

Shank	Drawbar Thread	For Saw Hole Sizes
MT2	M10	1/2, 5/8, 3/4, 7/8 & 1"

STRAIGHT SHANK DIE HOLDER

- Straight shank die holder for hand operations as well as for machines.
- Knurling body is provided for easy handlings.
- A durable and versatile solution for securely holding up to 25mm dies with a 10mm shank, ensuring reliable performance.
- Durable construction for longevity.
- Robust design for reliability.
- Fits machines with a 10mm chuck.
- Reliable performance in die-holding applications.
- Die capacity: 25mm
- Shank dia. 10mm
- Uses 13/16 & 1" O.D. round adjustable dies.

Item 3906-4901
Sale Price **\$1615** (F)



NEW
PRODUCTS
SAVE UP TO 15%

* Till May 31, 2024 *

MORSE TAPER TURNING ATTACHMENTS - For Lathe

- Made from alloy steel, hardened and ground.
- This attachment makes the taper turning operation much easier than before and gives you the freedom of old school method of off setting the tailstock for turning taper profile on lathe machine.
- 2 side knobs are being provided for fine and easy adjustments up to 6 degrees left and right.
- Graduation scale is being marked for user's reference where 1 division will offset the slide by 0.5 mm.

MT2 Shank	
Item	3906-5071
Sale Price	\$5879 (F)



MT3 Shank	
Item	3906-5072
Sale Price	\$5879 (F)

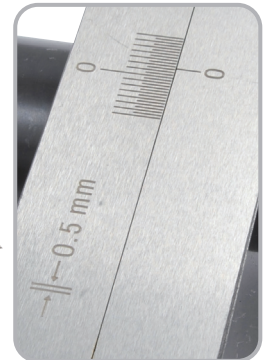

TEST/INSPECTION MANDRELS - MORSE TAPER

- Used for checking the alignment of machine spindle axis.
- Made of high grade tool steel
- Precision ground and heat treated for maximum concentricity.
- Serves to represent materially an axis of rotation, so that the axis can be checked for alignment.
- A mandrel mounted between centers provides a reference straight - line joining the two points (centers), so as to check the alignment of the centers.

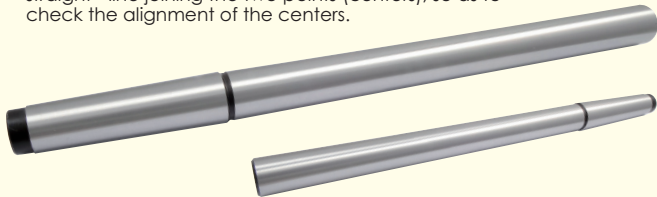

Item#	Morse Taper	Overall Length	Sale (F)
3906-4122	MT2	11-1/8	23.90
3906-4123	MT3	13-3/16	31.65
3906-4124	MT4	15-1/4	40.70

6" HEAVY DUTY AUTO CENTER PUNCH

- HHIP heavy-duty center punch creates a starting point for drilling by making a small dent in the work piece, ensuring accurate hole placement or for marking starting points in riveting, chiseling, metalworking alignment, woodworking, scoring, or engraving.
- No hammer required.
- Double spring loaded barrel.
- Special hardened alloy steel tip for instant marking.
- Knurled body and black oxidized.

Item	8070-0484
Sale Price	\$614 (F)



BALL TURNING ATTACHMENT FOR LATHE -Uses TNMG Insert

- The HHIP ball-turning attachment for a lathe helps shape spherical objects and cones on a lathe. It consists of a base, tool holder, and an adjustable mechanism to control the size of the ball.
- The tool holder positions the cutting tool; the attachment includes rotation control and stability features. This tool simplifies the process of turning balls on a lathe, making it more precise.
- The bearing base in our ball-turning attachment enables the cutting arm to rotate smoothly through the use of a handle.
- This tool fits straight onto the cross slide of your Myford and similar size lathes.
- Includes one indexable TNMG insert for best turning process.



Item	3906-5311
Sale Price	\$6780 (F)

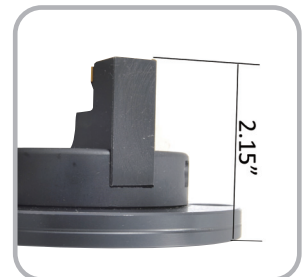

NEW
PRODUCTS
SAVE UP TO 15%

* Till May 31, 2024 *

TANG SCREWS FOR DRAWBAR END HOLDERS (INCH)

- Precision made from tool steel, hardened.
- Inch thread.

Item#	Morse Taper	Thread	Dimensions (mm)				Sale (F)
			D	L	L1	L2	
3906-0795	MT2	3/8"-16	12	30	7	4	5.78
3906-0796	MT3	3/8"-16	17	40	12	4	6.12
3906-0797	MT4	5/8"-11	24	46	13	5	6.78

Tang for draw bar
thread type holders



HARLINGEN® HIGH PRECISION CNC LIVE CENTERS

- High concentricity and stability thanks to high accuracy bearing system.
- Tip has 60° included angle.
- Body is hardened for extra strength and extra rigidity
- Lifetime lubrication for minimum required maintenance.
- Maximum concentricity deviation for ultra precision
- Point is made of high quality alloy steel, heat treated to hardness HRC62.

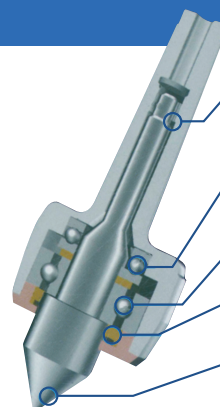
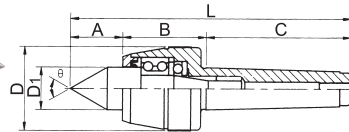
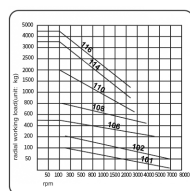

NEEDLE BEARING

Coarse clearance fit design in supporting structure counteracts heat preventing the deformation during use.

THRUST BALL BEARING

The bearing has a hardened frame providing good rigidity and accuracy strengthening the axial load.

BALL BEARING

The front support bearing provides high speed rotating and accuracy.

SEAL RING

Prevents coolant and other scraps from settling in extending centers life.

CENTER SPINDLE

made of high quality alloy steel, hardened to HRC62, which allows good rigidity and wearability.

Item#	Morse Taper	T.I.R.	Dimensions (Inch)					OAL (L)	Load Rate lbs.	Max. RPM	Weight lbs	Sale (F)
			A	B	C	D	D1					
9741-3232	2	.0002"	0.94	1.61	2.52	1.77	0.79	5.08	165	7000	1.10	119.12
9741-3233	3	.0002"	1.22	1.91	3.19	2.36	0.98	6.32	500	5000	2.86	143.99
9741-3234	4	.0002"	1.61	2.42	4.04	2.76	1.26	8.07	1000	3800	5.06	162.97
9741-3235	5	.0004"	1.99	3.09	5.10	3.54	1.57	10.18	1200	3000	10.34	251.98

HARLINGEN® HIGH PRECISION CNC LIVE CENTERS-EXTENDED POINT

- Especially suited for cramped work areas between center point and workpiece.
- High concentricity and stability provides high accuracy bearing system.
- Tip has 60° included angle.
- Body is hardened for extra strength and extra rigidity.
- Lifetime lubrication for minimum required maintenance.
- Maximum concentricity deviation for ultra precision
- Point is made of high quality alloy steel and heat treated to hardness HRC62.

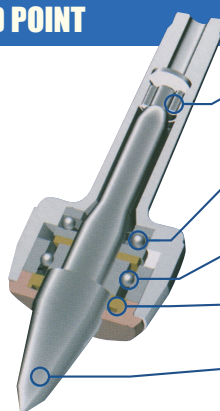
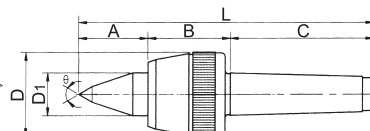
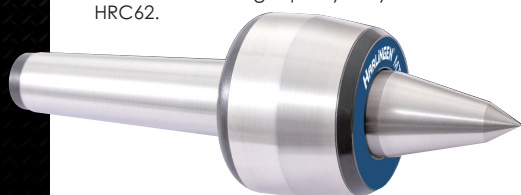
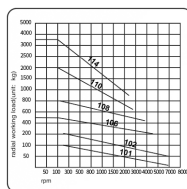

NEEDLE BEARING

Coarse clearance fit design in supporting structure counteracts heat preventing the deformation during use.

THRUST BALL BEARING

The bearing has a hardened frame providing good rigidity and accuracy strengthening the axial load.

BALL BEARING

The front support bearing provides high speed rotating and accuracy.

SEAL RING

Prevents coolant and other scraps from settling in extending centers life.

CENTER SPINDLE

made of high quality alloy steel, hardened to HRC62, which allows good rigidity and wearability.

Item#	Morse Taper	T.I.R.	Dimensions (Inch)					OAL (L)	Load Rate lbs.	Max. RPM	Weight lbs	Sale (F)
			A	B	C	D	D1					
9741-0232	2	.0002"	1.34	1.61	2.52	1.77	0.79	5.47	200	7000	1.50	134.17
9741-0233	3	.0002"	1.85	1.91	3.19	2.36	0.98	6.95	360	5000	3.25	160.35
9741-0234	4	.0002"	2.09	2.42	4.04	2.76	1.26	8.54	800	3800	6.20	192.42
9741-0235	5	.0004"	2.56	3.09	5.10	3.54	1.57	10.75	1200	3000	12.50	264.42



2PC SLOTTED ANGLE PLATE & 1-2-3 BLOCK COMBO SETS

3x2.5x2" Angle Plate & 1-2-3 BLOCK	
Item	9999-0005
Sale Price	\$3422 (F)

4.5x3.5x3" Angle Plate & 1-2-3 BLOCK	
Item	9999-0006
Sale Price	\$3806 (F)

6x5x4.5" Angle Plate & 1-2-3 BLOCK	
Item	9999-0007
Sale Price	\$5369 (F)

8x6x5" Angle Plate & 1-2-3 BLOCK	
Item	9999-0004
Sale Price	\$6745 (F)

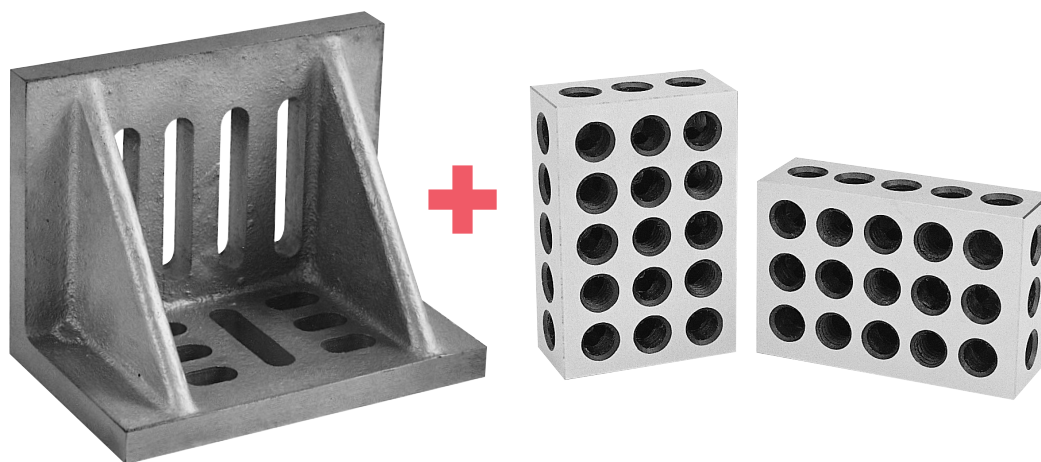

SLOTTED ANGLE PLATES -Webbed

- Made of high tensile cast iron properly seasoned against distortion.
- Clamping slots are widely used for machining, layout and inspection.
- Accurately machined and ground square and parallel on outside and ends.

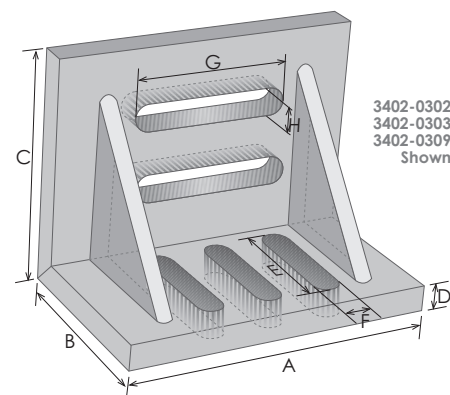
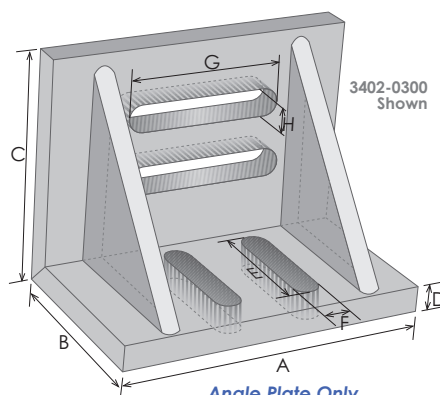

MACHINE TO .002 PER 6"

Angle Plate Only

Item#	(Inch)								Wt. (lbs)
	A	B		D	E	F	G	H	
3402-0300	3	2.5	2	9	40	10	37	10	5
3402-0302	4.5	3.5	3	12.5	50	11	70	11	7
3402-0303	6	5	4.5	13	74	12	86	12	11
3402-0309	8	6	5	15	98	14	105	14	17

PRECISION 1-2-3 BLOCK SET

- Heat treated and case hardened to HRC 55 to 60.
- Hardened and precision ground on all 6 sides of each block.
- Accuracy with squareness on all sides within .0002" per inch.

- 23 holes consists of 5 tapped holes (3/8" - 16 for 1-2-3) for clamping and 18 untapped holes drilled.
- Cross drilling design gives minimum weight and maximum strength.
- Dimensions: 1-2-3 is 1 x 2 x 3"

**MATCHED PAIRS
AND SOLD AS PAIR**

1-2-3 Block Set Only	
Item	3402-0005

5 Tapped Holes & 18 Untapped Through Holes

NEW PRODUCTS

SAVE UP TO 15%

* Till May 31, 2024 *

MIST COOLANT SPRAYER

- Economy coolant spray unit for a variety of applications using water or coolants.
- Three 5mm mounting holes in the base provide flexibility in locating the unit whose overall width is 46mm and height 40mm.
- The 31cm (12.2") spray hose is easily shaped to point your nozzle at the precise location needed.
- Brass nozzle and knobs prevent rust and surfaces are knurled for easy control.
- Air and coolant intakes use a push-type attachment. The air intake is 8mm and the liquid intake is 4mm.
- The fluid hose included has a 2.5mm internal diameter, a backflow preventer and a filter.

- Use with standard air compressor (not included) with pressure range of 30 - 150 PSI.
- The system is suitable for use with any type of soluble coolant or oil (non-corrosive).
- Use with fluids that have a viscosity at 68 cSt or less.

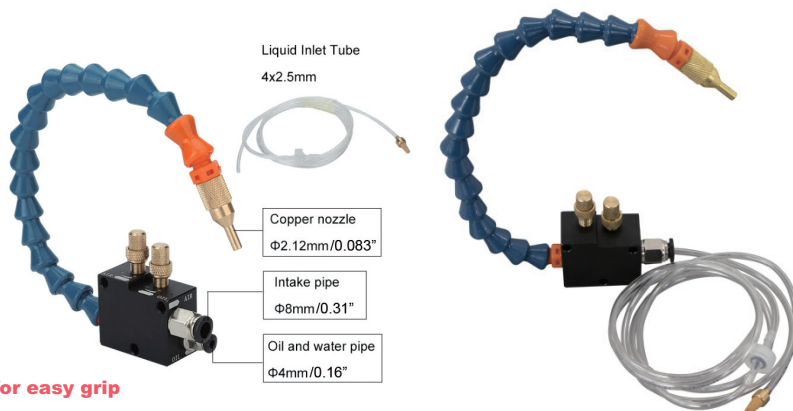

Item 8401-0199

Sale Price **\$3570** (F)

Flexible nozzle hose to reach any angle
Easy to connect line via push-in connections
Durable copper knobs for flow control, knurled surfaces for easy grip
Line filter and backflow preventor

53PC INCH/METRIC TRANSFER PUNCH COMBO SET

- Used for transferring threaded, drilled and tapped holes.
- Undersize .0025".
- Heat treated tempered tool steel for longer life.
- Black oxide finish.
- 28pc Set Range: 3/32~1/2" by 64ths & 17/32"
- 25pc Set Range: 1~33mm by 0.5mm

BUY COMBO SET & SAVE!



28PC & 25PC COMBO SET
 Range: 3/32~1" & 1-33mm

Item 8600-0054

Sale Price **\$3102** (F)

HIGH PRECISION STEEL PIN GAGE 990PC LIBRARY SET (0.011-1.000") WITH CUSTOM DRAWER SYSTEM

- Metal drawer system
- Minus set: $-0.0002"/+0.0000"$
- .001" set increments, sizes marked on each pin gage.
- Made of tool steel and hardened to HRC60~62
- Finish to 10 micro or better
- Class ZZ
- OAL: 2"
- 8 pin gage handles included

Accuracy $-0.0002"/+0.0000"$

Application:

- Checking locations
- Measuring hole sizes and depths
- Go and No-Go gaging
- Setting micrometers
- Checking distances between holes



990 PC SET
 0.011~1.000" Range
 Item 4101-0060
 Sale Price **\$1,78245** (E)
 Wt. 249 Lbs.





Pro-Series 6PC OPTICAL CENTER PUNCH SET

- This Optical Punch Set is indispensable when doing critical layout work. Just look down the magnifying lens and align the cross hairs or center of circle with the mark on your workpiece. Replace the magnifier with the supplied hardened tool steel punch and give it a tap.
- Punch set Includes:** a bull's eye with cross hair lens, a bull's eye with center dot and circle lens, a 60 degree punch, a 120 degree punch and a precisely manufactured of aluminum main body and a fitted case.

Lens Magnifier Power: 9x
Punch Size: 3/8"
Pin Length: 1.85"
Main Body Diameter: 1.9"



DRILL CHUCK WITH KEY & ARBOR KITS

- Accurate and strong gripping force.
- For portable, bench or floor type drill presses.
- Arbors are hardened and ground.
- Supplied with chuck key.

MT Shank
9999-0008 Shown

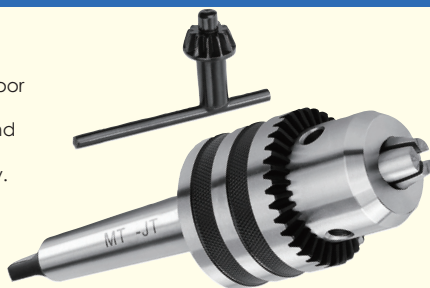

STRAIGHT SHANK
9999-0013 Shown



**BUY A
KIT
& SAVE!**

R8 Shank
9999-0020 Shown

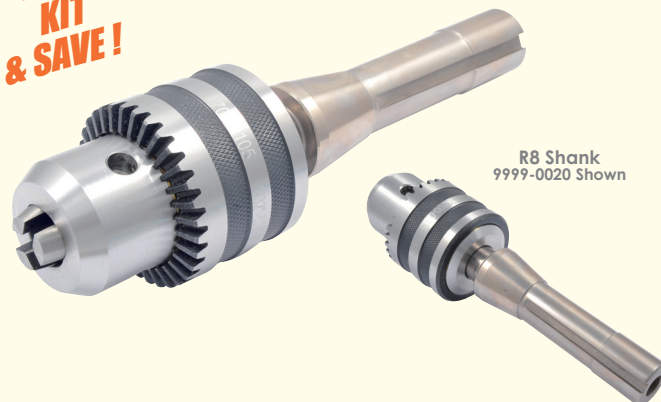

Item#	Clamping Capacity	Taper Mount	Arbor Included	Sale (F)
9999-0008	1/32~3/8"	JT2	MT2	22.16
9999-0009	1/32~3/8"	JT2	1/2" Straight	20.81
9999-0010	1/32~3/8"	JT2	R8	25.83
9999-0011	1/32~1/2"	JT33	MT2	23.60
9999-0012	1/32~1/2"	JT33	MT3	24.32
9999-0013	1/32~1/2"	JT33	1/2" Straight	21.85
9999-0014	1/32~1/2"	JT33	5/8" Straight	23.92
9999-0015	1/32~1/2"	JT33	R8	27.27
9999-0016	1/8~5/8"	JT3	MT3	26.07
9999-0017	1/8~5/8"	JT3	MT4	29.02
9999-0018	1/8~5/8"	JT3	5/8" Straight	25.92
9999-0019	1/8~5/8"	JT3	3/4" Straight	24.62
9999-0020	1/8~5/8"	JT3	R8	29.02
9999-0022	3/16~3/4"	JT3	3/4" Straight	53.86
9999-0023	3/16~3/4"	JT3	R8	58.63

NEW PRODUCTS

SAVE UP TO 15%

* Till May 31, 2024 *

SQUARE SHOULDER MT3 INDEXABLE END MILL

- Accepts APKT(10mm) Carbide Inserts

- 90° square shoulder milling.
- Used for slotting and peripheral milling.
- Uses standard APKT-1003 inserts (included).
- Cost effective.
- Drawbar Thread: M12x1.75

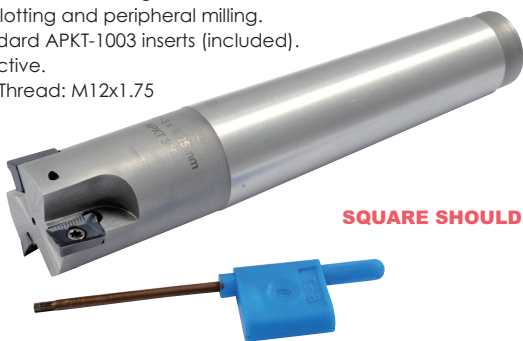

SQUARE SHOULDER

Item#	Cutter Dia.	Shank Dia. (mm)	OAL	No of Inserts	Use Insert	Screw	Torx Wrench	Sale (F)
5896-1022	25	MT3	128	3	APKT1003	M2.5x6	T8	40.38



INSERT - Replacement

Item #	Size	Sale (F)
6010-4203	APKT1003	10.58

SCREWS - Replacement

Item #	Size	Sale (F)
2100-0070	M2.5x6	3.09

TORX WRENCH - Replacement

Item #	Size	Sale (F)
2100-0092	T8	2.64

BELL PUNCH CENTER FINDER

- Bell punch easily locates and allows center punching of ends on round stock of up to 35mm
- Hardened to 48-52 HRC.
- A very handy tool if with you require precise drilling on round bar.

Item B606-7006
Sale Price **\$2067 (E)**



HARLINGEN® HIGH PRECISION 5C COLLETS



- Clamping nose HRC55, body HRC40 and thread HRC25.
- Engineered for precise machining.
- Roughness Ra 0.4
- Internal and external thread machining after heat treatment reduces deformation, burrs and provides you with smooth threaded engagement.
- "STEP" Hardened and Ground Surface throughout protects the connection with spindle, also guarantees high accuracy, durability and long tool life.

Run-out accuracy
≤ 0.0006 INCHES at 3xD



MADE OF HIGH GRADE TOOL STEEL

Item#	Size	Sale (F)	Item#	Size	Sale (F)
9742-3003	1/16"	11.87	9742-3038	39/64"	11.87
9742-3005	3/32"	11.87	9742-3039	5/8"	11.87
9742-3006	7/64"	11.87	9742-3040	41/64"	11.87
9742-3007	1/8"	11.87	9742-3041	21/32"	11.87
9742-3008	9/64"	11.87	9742-3042	43/64"	11.87
9742-3009	5/32"	11.87	9742-3043	11/16"	11.87
9742-3010	11/64"	11.87	9742-3044	45/64"	11.87
9742-3011	3/16"	11.87	9742-3045	23/32"	11.87
9742-3012	13/64"	11.87	9742-3046	47/64"	11.87
9742-3013	7/32"	11.87	9742-3047	3/4"	11.87
9742-3014	15/64"	11.87	9742-3048	49/64"	11.87
9742-3015	1/4"	11.87	9742-3049	25/32"	11.87
9742-3016	17/64"	11.87	9742-3050	51/64"	11.87
9742-3017	9/32"	11.87	9742-3051	13/16"	11.87
9742-3018	19/64"	11.87	9742-3052	53/64"	11.87
9742-3019	5/16"	11.87	9742-3053	27/32"	11.87
9742-3020	21/64"	11.87	9742-3054	55/64"	11.87
9742-3021	11/32"	11.87	9742-3055	7/8"	11.87
9742-3022	23/64"	11.87	9742-3056	57/64"	11.87
9742-3023	3/8"	11.87	9742-3057	29/32"	11.87
9742-3024	25/64"	11.87	9742-3058	59/64"	11.87
9742-3025	13/32"	11.87	9742-3059	15/16"	11.87
9742-3026	27/64"	11.87	9742-3060	61/64"	11.87
9742-3027	7/16"	11.87	9742-3061	31/32"	11.87
9742-3028	29/64"	11.87	9742-3062	63/64"	11.87
9742-3029	15/32"	11.87	9742-3063	1	11.87
9742-3030	31/64"	11.87	9742-3064	1-1/64"	11.87
9742-3031	1/2"	11.87	9742-3065	1-1/32"	11.87
9742-3032	33/64"	11.87	9742-3066	1-3/64"	11.87
9742-3033	17/32"	11.87	9742-3067	1-1/16"	11.87
9742-3034	35/64"	11.87	9742-3068	1-5/64"	11.87
9742-3035	9/16"	11.87	9742-3069	1-3/32"	11.87
9742-3036	37/64"	11.87	9742-3070	1-7/64"	11.87
9742-3037	19/32"	11.87	9742-3071	1-1/8"	11.87